



Maryland Way, TW16

£1,200,000

Dexters



Maryland Way, TW16

An extended and fully refurbished four/five bedroom detached house with off street parking. This spacious family home offers over 2600 sq ft of flexible accommodation and is ideal for an up-sizing family looking for a house that they can just move straight into.

On the ground floor there is a welcoming entrance hallway, a front reception room that could be used as a fifth bedroom, an incredible double reception room divided by a feature fireplace, modern kitchen, utility room, an additional shower room and a home office. There is the added bonus of a self contained annex, which could be used to bring in an additional income or be ideal for a relative.

On the first floor there is a stunning master bedroom with an en suite shower room and a walk in wardrobe. Two further double bedrooms and a family bathroom.

To the front of the house there is off street parking for at least three cars and access to the garage. To the rear there is a charming garden with a patio that is perfect for entertaining and a lawn.

Maryland Way is an amazing location, this quiet road is located within the popular Berg development in the heart of Lower Sunbury. The local village shops, the River Thames and riverside pubs, Sunbury Park and Sunbury station are all close by.

Features

- Detached
- Four/Five Bedrooms
- Four Bathrooms
- Self Contained Annex
- Off Street Parking
- Amazing Location







Maryland Way, Sunbury-On-Thames, TW16

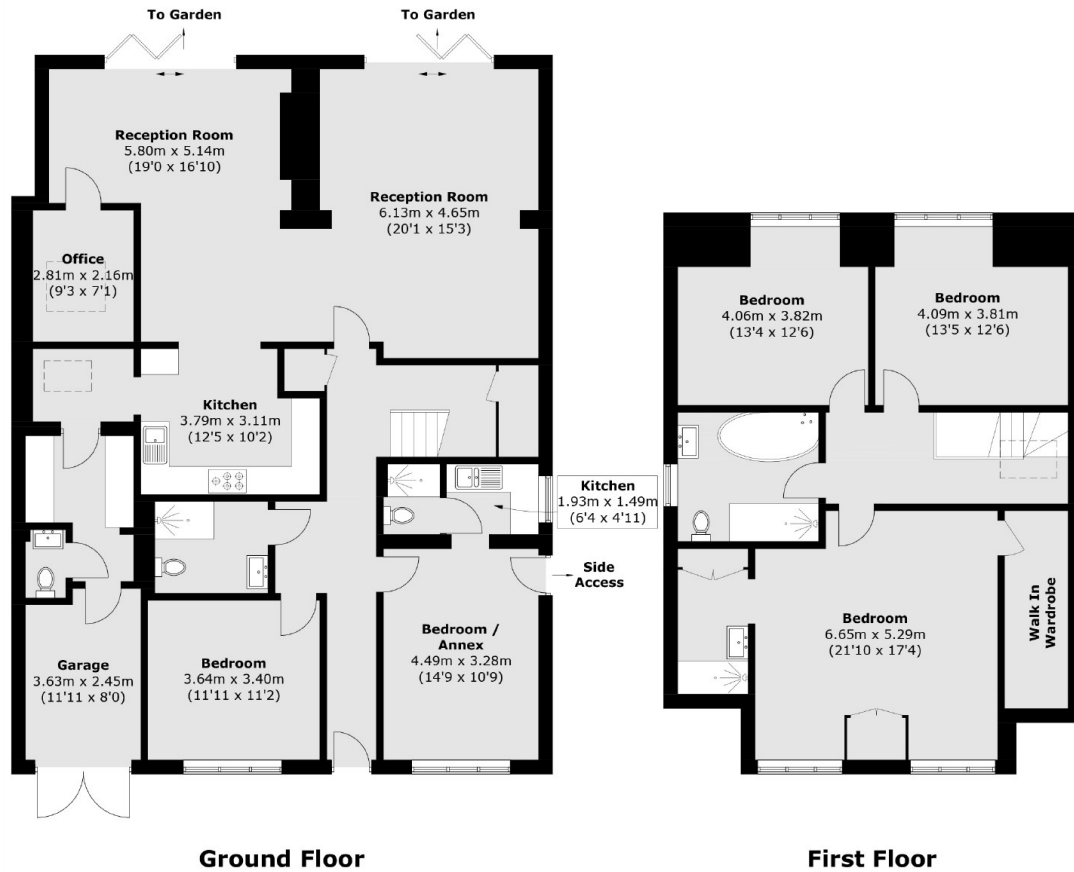

Total area (approx.): 246 sq. m (2,647.8 sq. ft)
(Including Garage)