



## King George Close, TW16

£360,000

A two bedroom end of terrace house with an allocated parking space. The property is smartly presented throughout with the added bonus of no onward chain. The new owner would just need to unpack to start enjoying their new home.

King George Close is a great location tucked away off Groveley Road. King George's Field is right next door which is ideal for walking the dog or for the kids to run around. Sunbury Station is just over half a mile away.

### Features

- Freehold
- End Of Terrace
- Two Bedrooms
- Private Garden
- Smartly Presented
- Allocated Parking

# King George Close, Sunbury-On-Thames, TW16

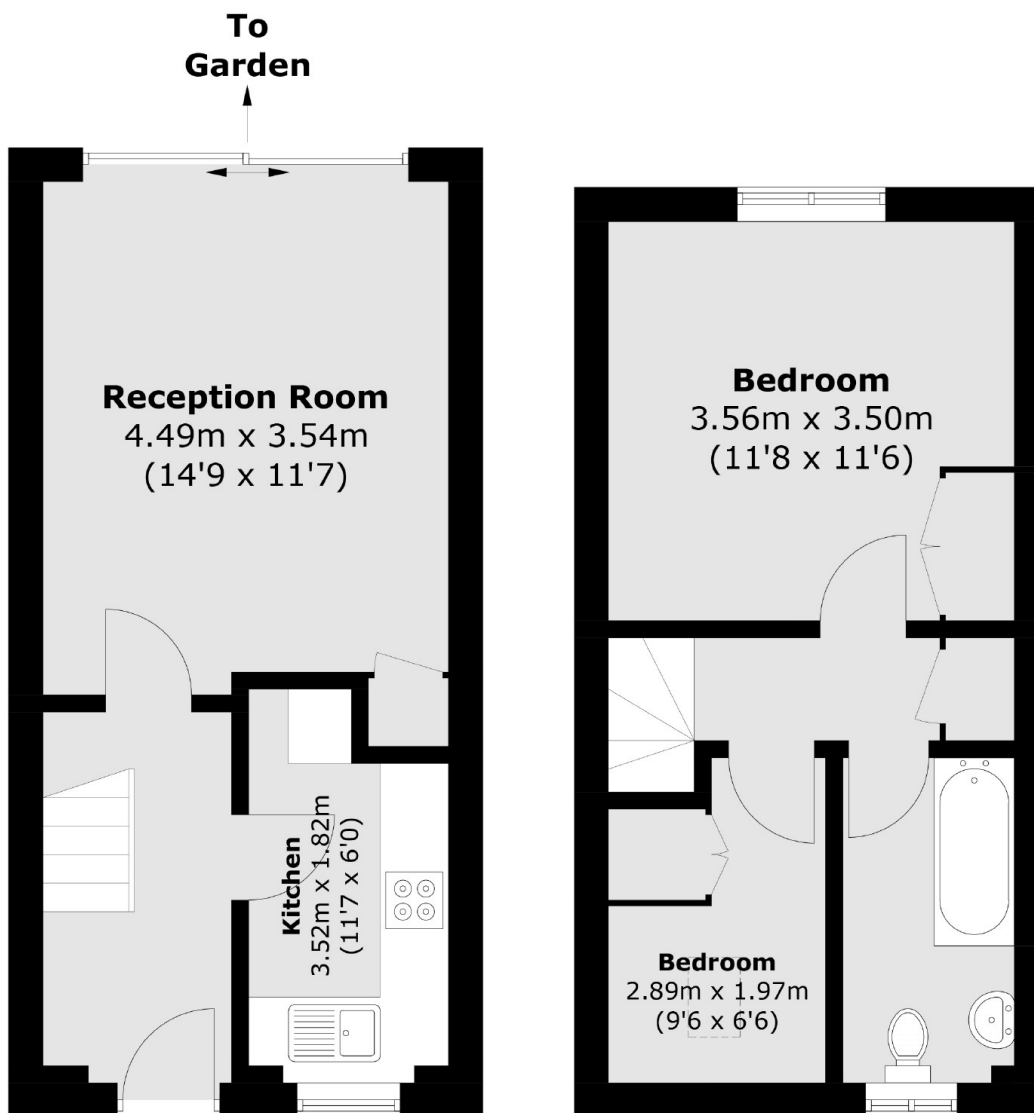

**Ground Floor**

**First Floor**

Total area (approx.): 55.4 sq. m (596.3 sq. ft)