



Kenton Avenue, TW16

£687,000

A four bedroom town house on a large corner plot with potential to extend (STPP). This property offers a flexible layout with over 1700 sq ft of accommodation spread over three floors, this spacious family home is full of scope and potential.

Kenton Avenue is a popular residential road located in Lower Sunbury between Staines Road East and Lower Hampton Road providing easy access to the River Thames. Additionally the local shops in Sunbury Village and Hampton are both easily accessible.

Features

- Town House
- Four Bedrooms
- Flexible layout
- Off Street Parking
- Two Bathroom/Shower Rooms
- Large Garden



Kenton Avenue, TW16

On the ground floor there is a welcoming entrance hallway, a shower room, fourth bedroom which could also be used as an additional reception room, conservatory and a large utility room.

On the first floor there is an spacious L-shaped reception room and a family kitchen. On the top floor there are three bedrooms and a family bathroom.

To the front of the property there is off street parking for three cars. To the rear there is an amazing wrap around garden offering multiple possibilities for extension or further development (STPP).



Kenton Avenue, Sunbury-On-Thames, TW16

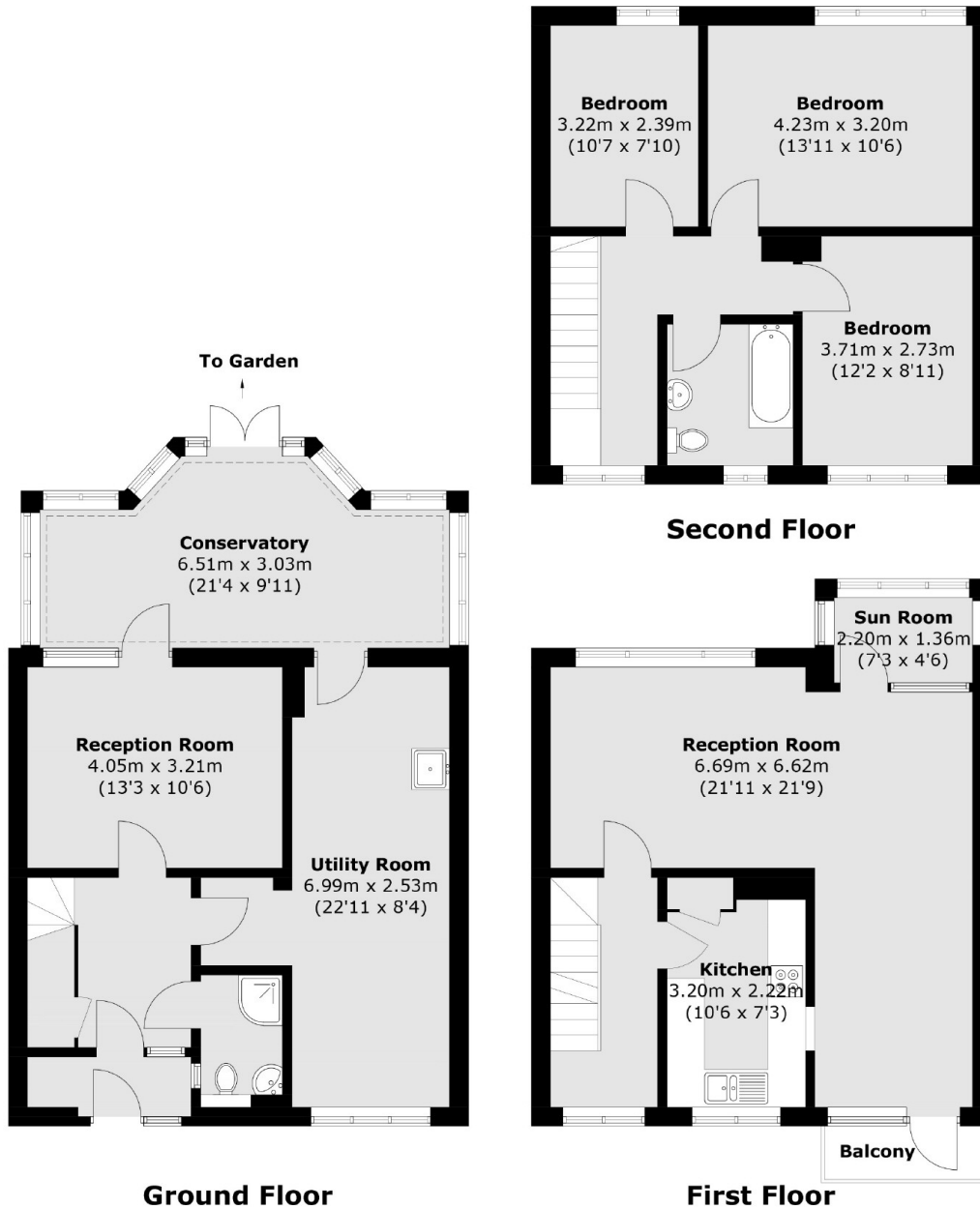

Total area (approx.) : 162.2 sq. m (1,745.8 sq. ft)
Balcony : 2.2 sq. m (23.7 sq. ft)