



Reedsfield Road, TW15

£335,000

A smartly presented, two bedroom ground floor maisonette with residents parking and direct access on to the communal gardens. The property has a light and spacious feel and would be a perfect first home.

Reedsfield Court is located off Reedsfield Road and Clockhouse Lane, Ashford Station and the High Street are approximately half a mile away. Heathrow Airport is also easily accessible.

Features

- Ground Floor
- Two Bedrooms
- Communal Gardens
- Garage
- Parking
- Smartly Presented

Reedsfield Road, Ashford, TW15

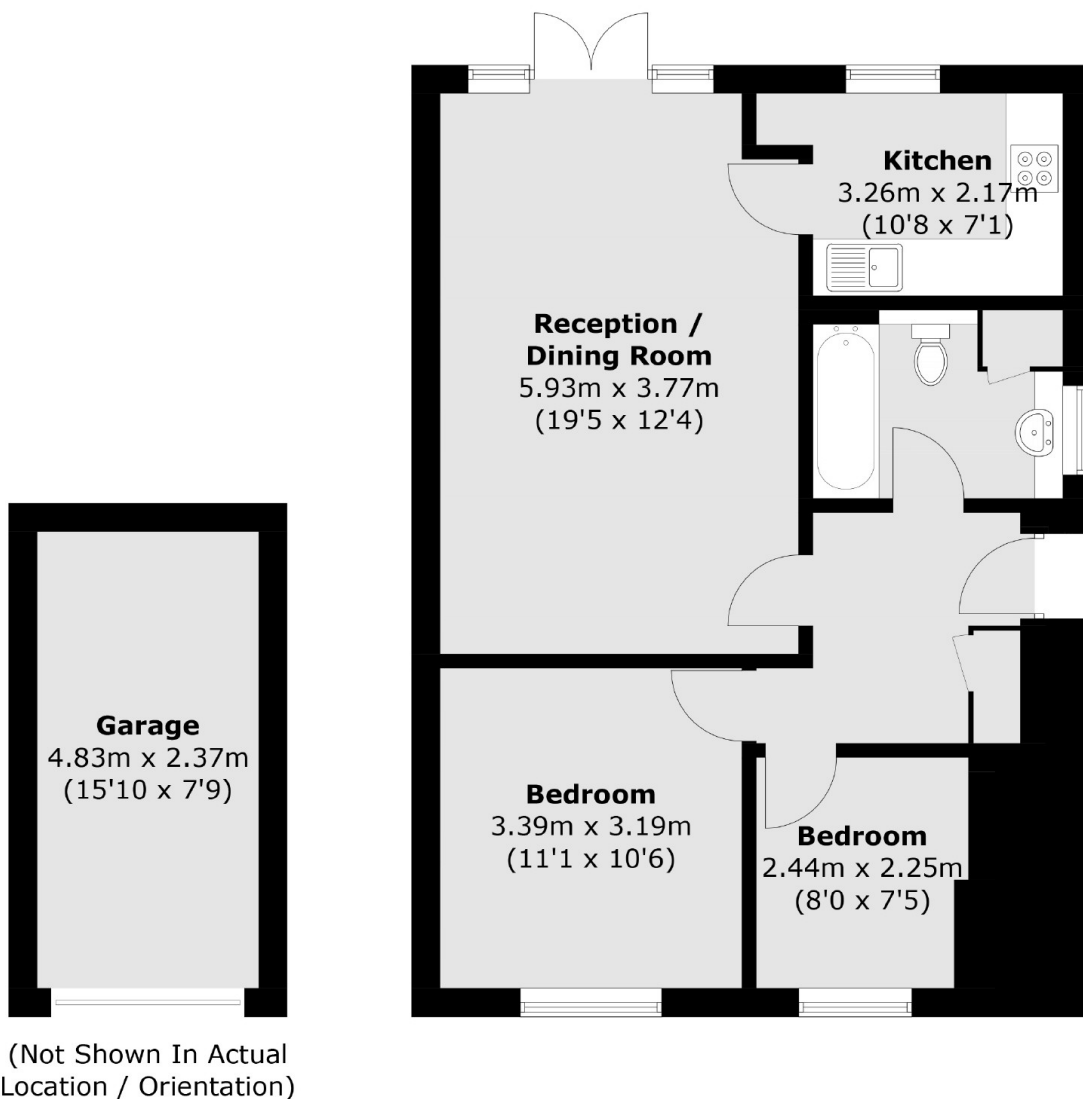

Total area (approx.): 59.2 sq. m (637.2 sq. ft)
Garage (approx.): 11.4 sq. m (122.7 sq. ft)