



Glebe Side, TW1

£3,200 Per calendar month

This four bedroom home offers a modern kitchen that opens into the conservatory dining area and a large patio garden, this property is perfect for professional sharers or families alike.

Conveniently located for Twickenham and Richmond town centre's with it's variety of shops, bars and restaurants. There are also many great state and private schools in the area.

Features

- Four Bedroom House
- Driveway Parking
- Garden Storage
- Bright Conservatory
- Modern Kitchen
- Patio Garden

Glebe Side, Twickenham, TW1

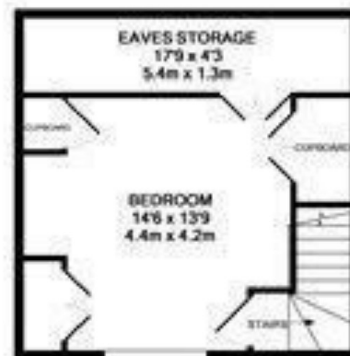
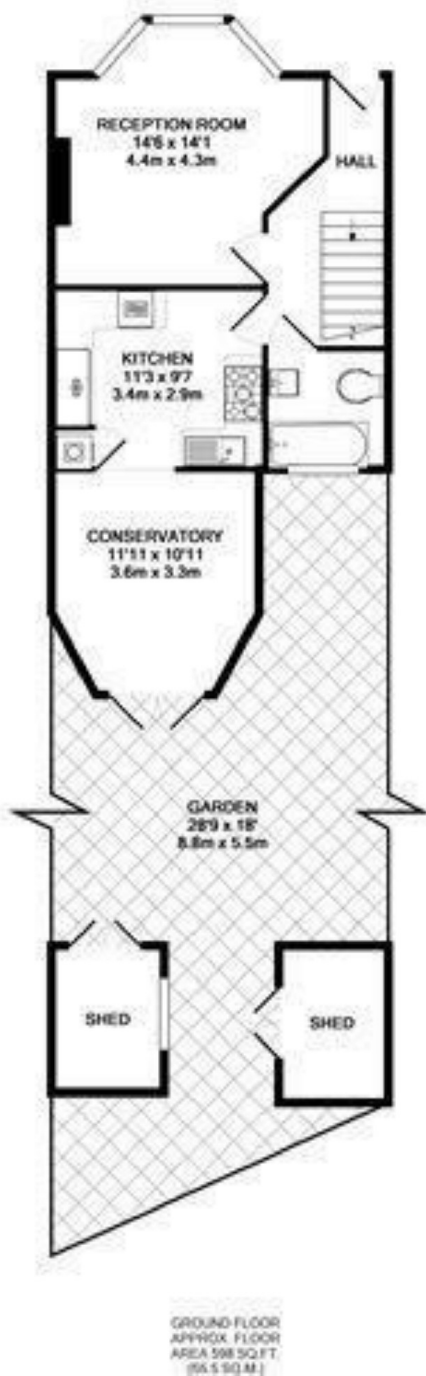

1ST FLOOR
APPROX. FLOOR
AREA 369 SQ. FT.
(34.2 SQ. M.)

GLEBE SIDE
TOTAL APPROX. FLOOR AREA 1286 SQ. FT. (119.4 SQ. M.)

Whilst every attempt has been made to ensure the accuracy of the floor plan contained here, measurements of doors, windows, rooms and any other items are approximate and no responsibility is taken for any error, omission, or mis-statement. This plan is for illustrative purposes only and should be used as such by any prospective purchaser. The services, systems and appliances shown have not been tested and no guarantee as to their operability or efficiency can be given.
Made with Metropix i320i