



Rosecroft Gardens, TW2

£549,950

Offered with no onward chain, this two double-bedroom bungalow provides an open reception and dining space, garage, generous further extension potential STPP and a large garden.

Rosecroft Gardens is situated within the ever popular Rosebine development, which is close to many excellent schools within the Richmond Borough, and offers convenient access to routes into London and towards the M3 and M25.

Features

- Semi-Detached Bungalow
- Two Double Bedrooms
- Large Garden
- Potential To Extend STPP
- Garage
- No Onward Chain

Rosecroft Gardens, Twickenham, TW2

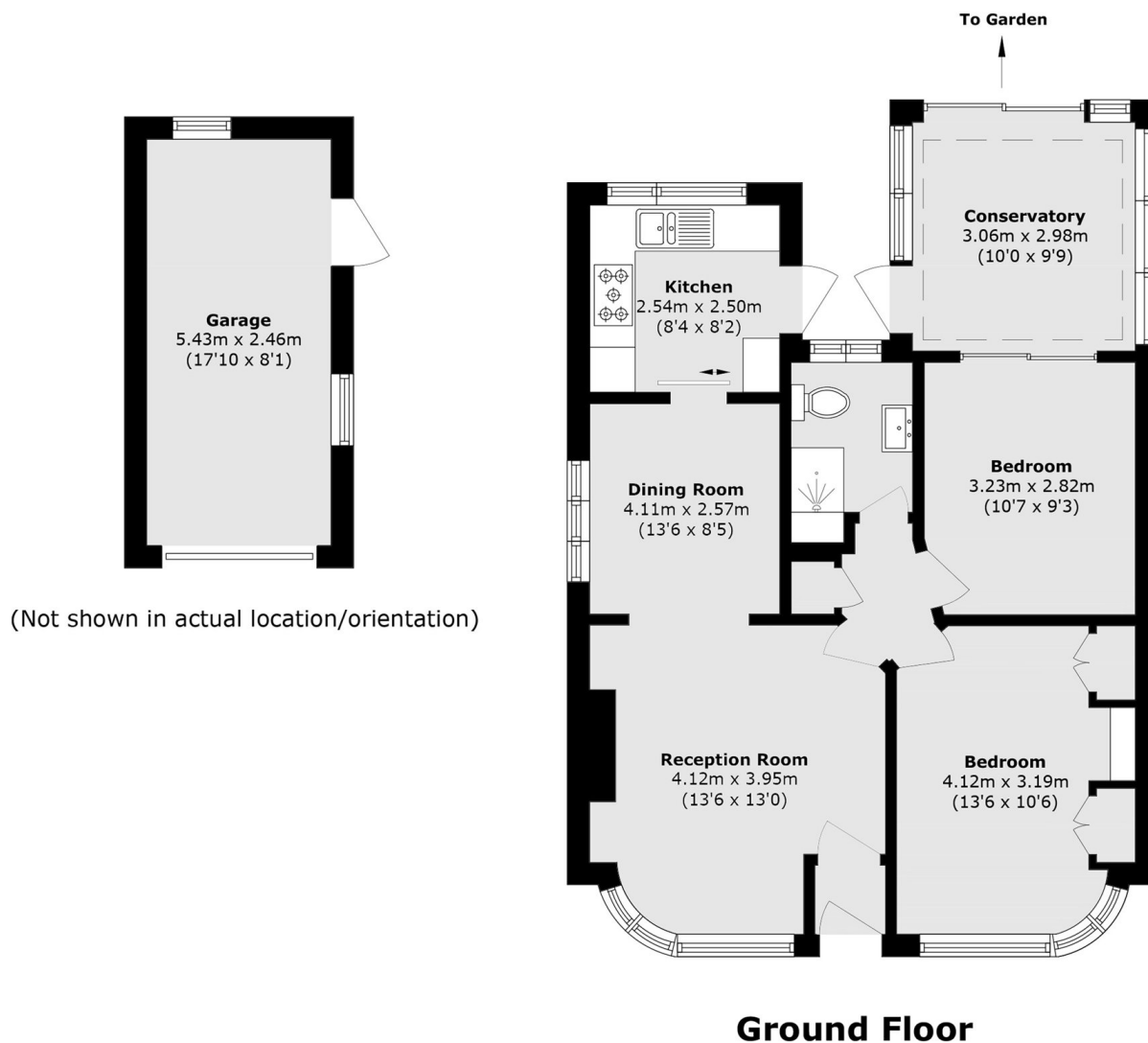

Total area (approx.): 69.3 sq. m (745.9 sq. ft)
(Excluding Garage)
Garage (approx.): 13.3 sq. m (143.1 sq. ft)