



## Saville Road, TW1

### £999,950

Offered with no onward chain is this spacious three bedroom 1930's house that would be a wonderful family home for years to come. In need of some cosmetic updating this fabulous house also benefits from having generous potential to extend into the loft and at the rear.

Saville Road is a premier road located off Twickenham high street where you will find a vast array of shops, pubs and restaurants. The mainline station with its fast link to Waterloo is less than a mile away and there are also a number of excellent schools nearby.

### Features

- Three Bedrooms
- No Onward Chain
- Central Location
- Potential To Extend
- Private Rear Garden
- Excellent School Catchments

# Saville Road, Twickenham, TW1

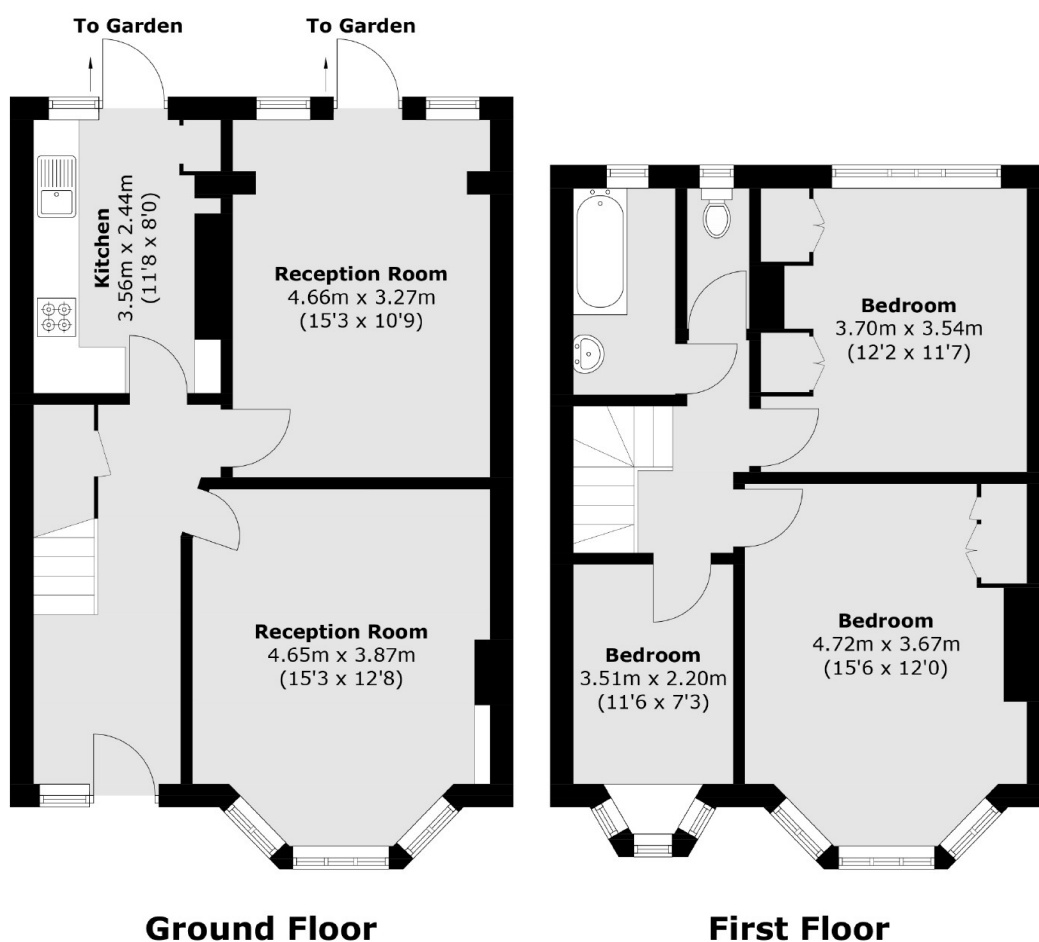

Total area (approx.): 101.6 sq. m (1,093.6 sq. ft)