



## Collingwood Close, TW2

£549,950

Offered with no onward chain is this spacious three bedroom end of terrace house that benefits from having a large rear garden with an outbuilding, side access and potential to extend the house further if required.

Collingwood Close is a quiet residential cul-de-sac off Nelson Road which leads to Whitton high street where you will find a vast array of shops, pubs and cafés including Starbucks. The area is also ideal for commuters as there is a fast link to London Waterloo via the mainline station and there are also a number of good schools nearby.

### Features

Three Bedrooms  
No Onward Chain  
Large Rear Garden  
Potential To Extend  
Outbuilding  
Side Access

# Collingwood Close, Whitton, TW2

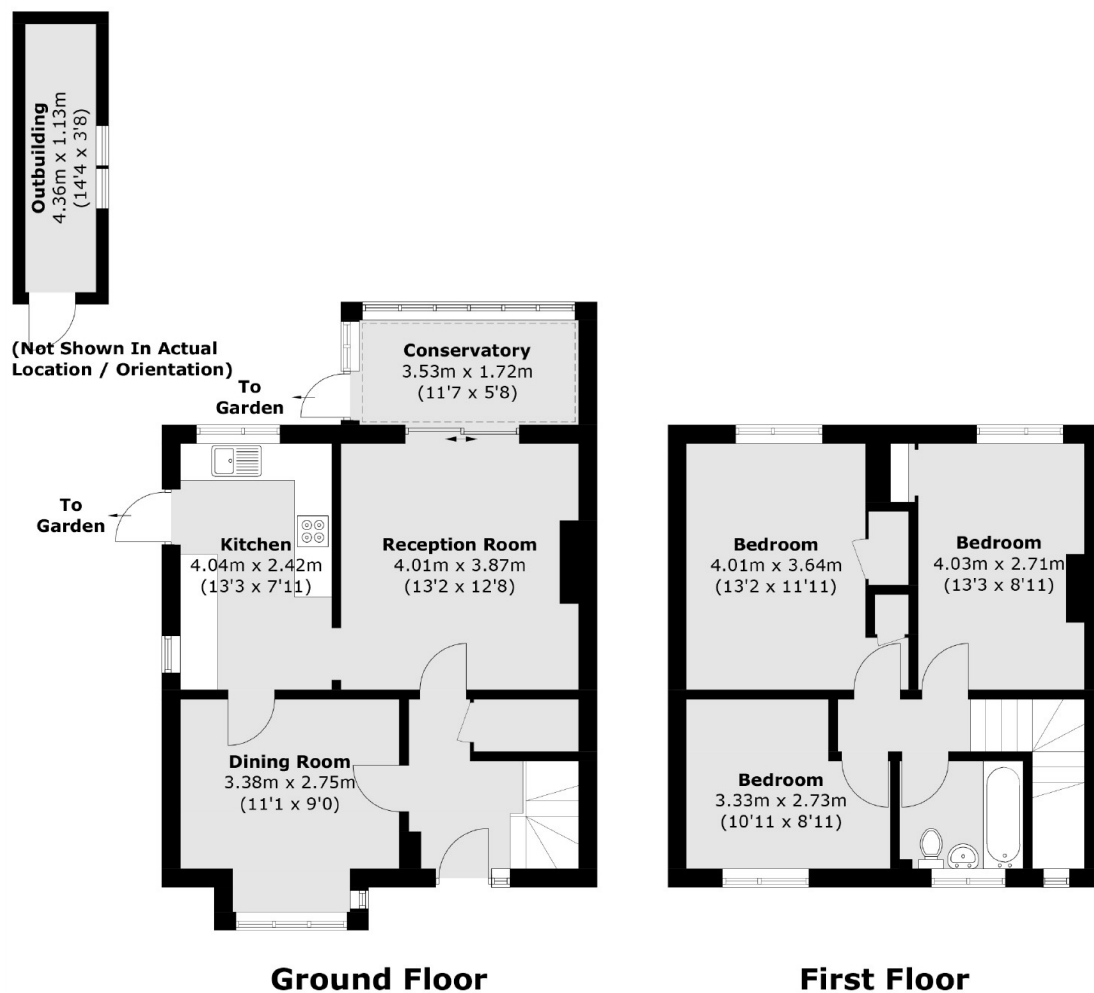

Total area (approx.): 97.8 sq. m (1,052.6 sq. ft)  
Outbuilding: 5.0 sq. m (53.8 sq. ft)