



Redfern Avenue, TW4

£325,000

Offers over £325,000. Offered with no onward chain is this bright and spacious first floor two bedroom purpose built maisonette that benefits from having a large private garden and a long lease with low charges.

Redfern Avenue is a popular street close to Powder Mill Lane where you will find various bus routes in and out of Whitton, Hounslow and Hanworth. Whitton mainline station offers a fast link to London Waterloo.

Features

- Two Bedrooms
- No Onward Chain
- First Floor
- Large Private Garden
- Recently Renovated
- Long Lease And Low Charges

Redfern Avenue, Whitton, TW4

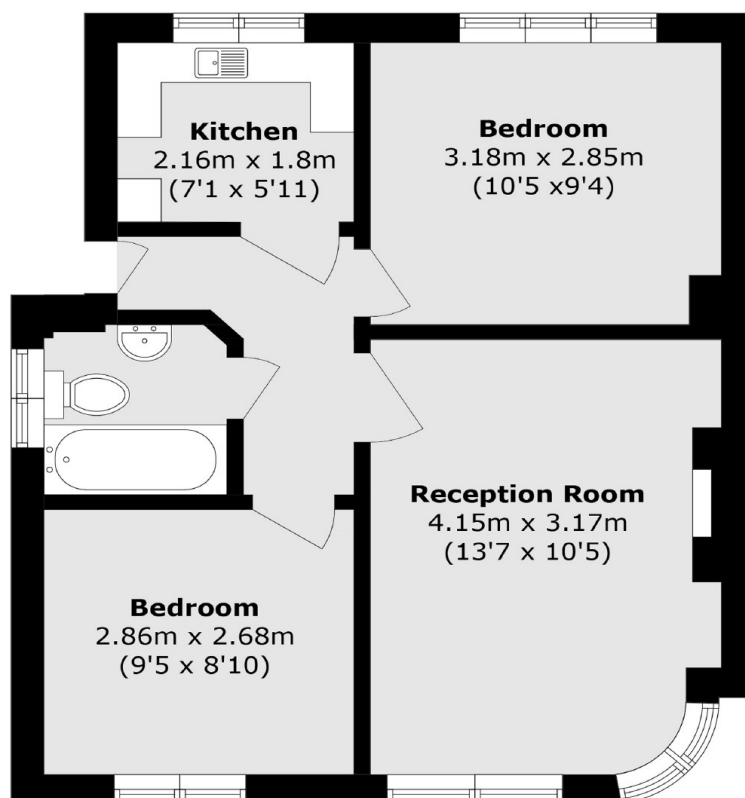

Total area (approx.): 43.3 sq. m (466.0 sq. ft)