



## Queens Road, TW1

£475,000

This two bedroom ground floor flat is perfect for anyone wanting to live in the centre of town. Art deco features like parquet flooring make this flat a little different alongside the benefit of a shared rear garden and no onward chain.

Queens Road is centrally located for access onto Twickenham high street where you will find a vast array of shops, pubs and restaurants. The mainline station with fast links to Waterloo is only a few hundred yards away. The river Thames and the famous Eel Pie Island are also within a short walk.

### Features

Two Bedrooms  
Ground Floor Flat  
Shared Garden  
No Onward Chain  
Separate Kitchen  
Parquet Flooring

# Queens Road, Twickenham, TW1

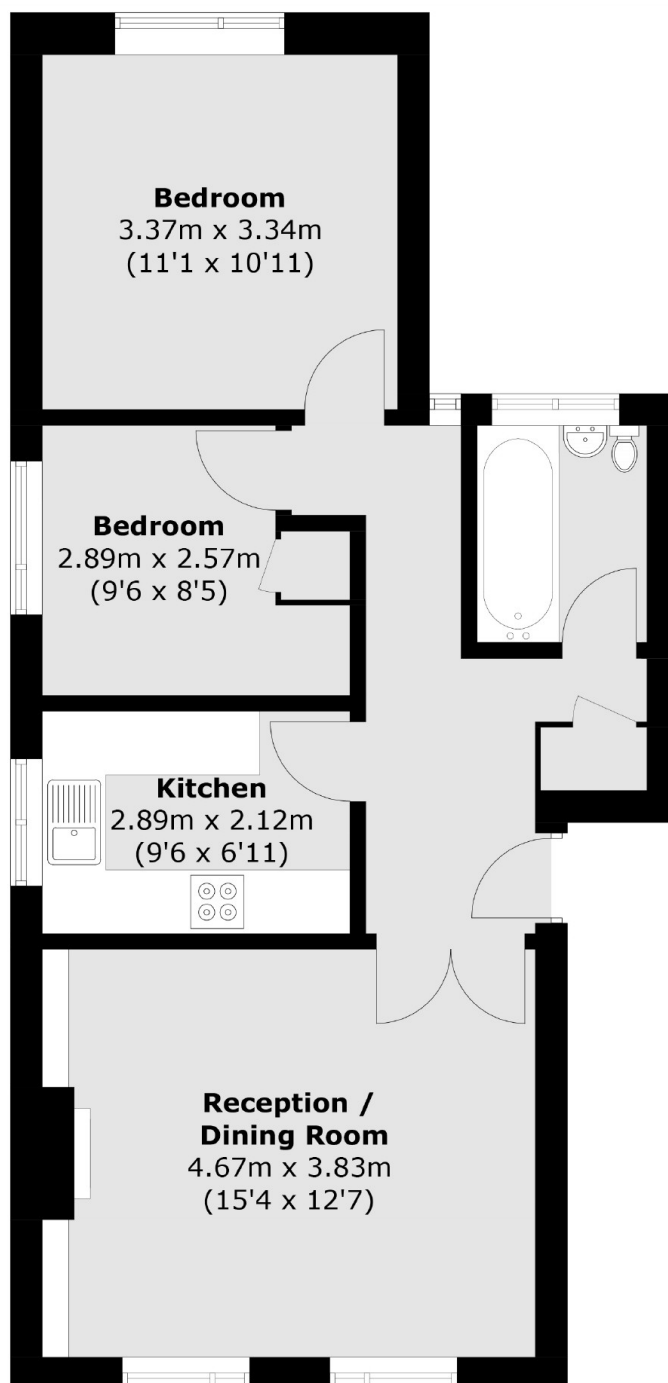

Total area (approx.): 56.4 sq. m (607.1 sq. ft)