



## Nelson Road, TW2

£775,000

This fantastic three bedroom detached house could be a wonderful family home for years to come as it benefits from having two bathrooms, a downstairs W.C, off street parking, a garage and generous potential to extend and develop if required.

Nelson Road is situated just off Whitton high street where you will find a vast array of shops, pubs, and cafés including independent coffee shops and bakeries as well as Starbucks. The area is also ideal for commuters as there is a fast link to London Waterloo via the mainline station and there are also a number of good schools nearby.

### Features

- Three Bedrooms
- Two Bathrooms
- Detached
- Off Street Parking
- Garage
- Potential To Extend & Renovate

# Nelson Road, Whitton, TW2

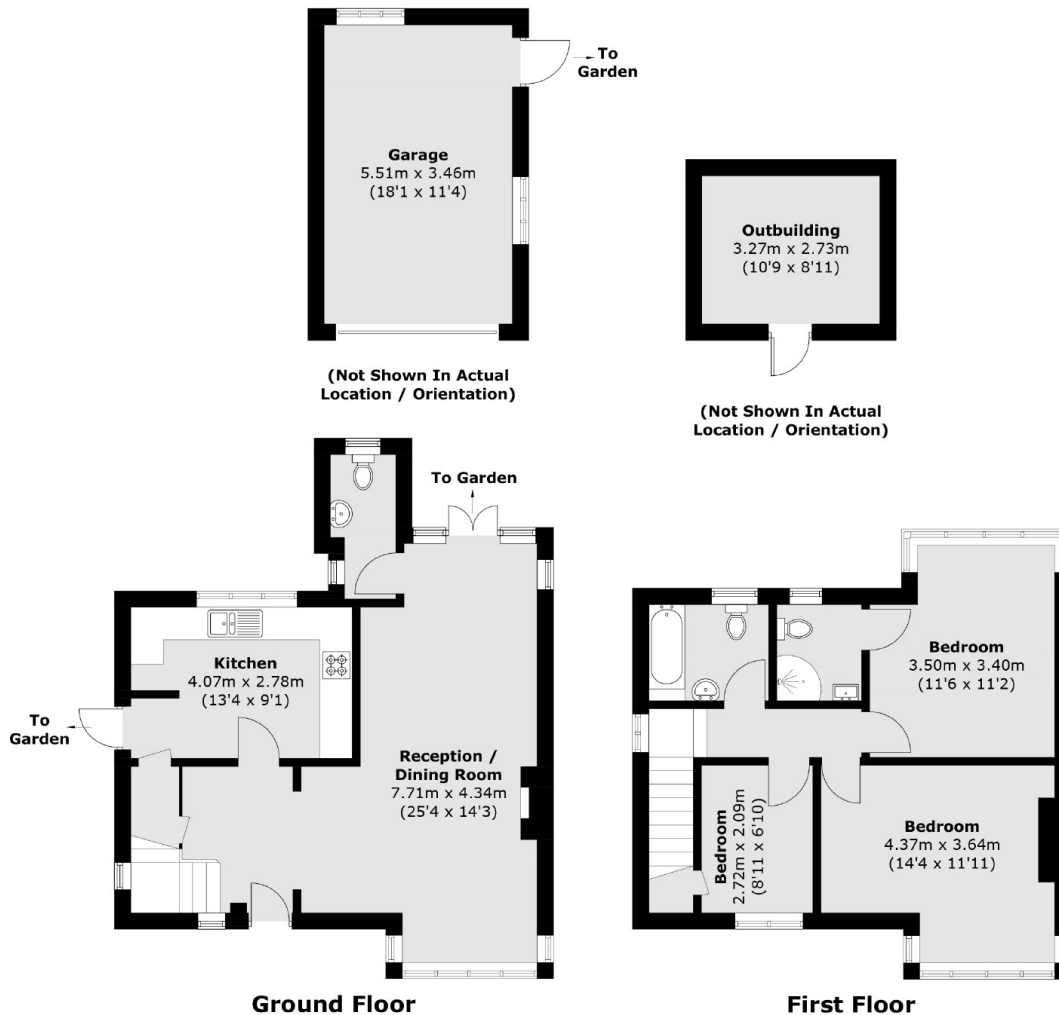

Total area (approx.): 98.2 sq. m (1,057.0 sq. ft)

Garage: 19.2 sq. m (206.7 sq. ft)

Outbuilding: 8.9 sq. m (95.8 sq. ft)