



## Cole Park Road, TW1

### £1,450,000

A generously sized four bedroom three storey house with views over Moor Mead Park and the river crane. This great family home has been extended in recent years and is offered to the market with no onward chain.

This central location means you have easy access to both central Twickenham with its excellent train links and large shopping options as well as the boutiques and coffee shops of St Margarets.

### Features

- Large Plot
- Modern Finishes
- Four Bedrooms
- Two Bathrooms
- Off Road Parking For Four Cars
- Enviably Location



## Cole Park Road, TW1

As you enter the house on the left you will find a double reception with french doors to the front and rear. There is an opening to a modern kitchen which also benefits from great views over the garden. The garage has been reduced in size to accommodate a large utility room and external storage.

Upstairs over two floors are four bedrooms and two bathrooms. As with the rest of the house, all the rooms have large windows allowing light to flood in. The top floor rear bedroom also has the added benefit of a balcony which allows you to enjoy the views over the park and River Crane.

The garden to the rear is mainly paved with mature planting and leads down to the River Crane with the park beyond this. To the front of the house, the wide corner plot gives you the added benefit of parking for four cars, comfortably.





# Cole Park Road, Twickenham, TW1

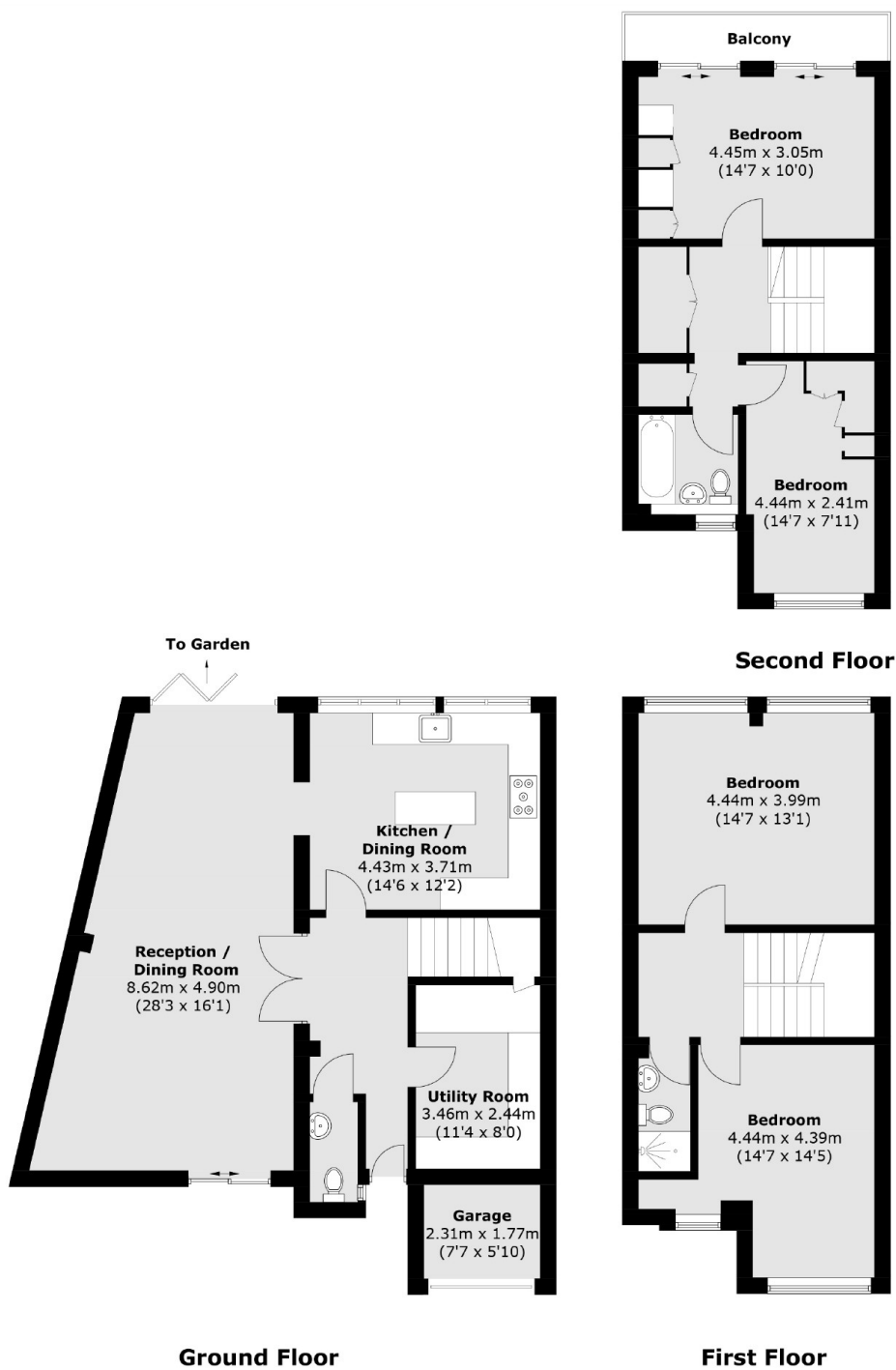

Main house total area (approx.): 160.0 sq. m (1,722.1 sq. ft)  
 Main house & garage area (approx.): 164.1 sq. m (1766.2 sq. ft)  
 Balcony area (approx.): 4.3 sq. m (46.2 sq. ft)

## Dexters

Twickenham  
 84 Heath Road  
 Twickenham  
 TW1 4BW  
 Sales  
 020 8744 0074

Energy Rating: D. We aim to make our particulars both accurate and reliable. However they are not guaranteed; nor do they form part of an offer or contract. If you require clarification on any points then please contact us, especially if you're traveling some distance to view. Please note that appliances and heating systems have not been tested and therefore no warranties can be given as to their good working order.

**RICS** Regulated  
 Estate Agent  
 and Letting Agent

dexters.co.uk