



Churchview Road, TW2

£335,000

Offered with no onward chain is this lovely two double bedroom ground floor property situated in a popular development. The property benefits from having a beautiful communal garden with direct access.

Oakley Court is at the top of Churchview Road which is close to excellent schools such as Waldegrave Girls and Trafalgar. Twickenham Green and the high street is also less than a mile away which offers a wide variety of shops, pubs and restaurants.

Features

- Two Double Bedrooms
- Ground Floor Flat
- No Onward Chain
- Communal Gardens
- Popular Development
- Circa 97yrs Lease Remaining

Churchview Road, Twickenham, TW2

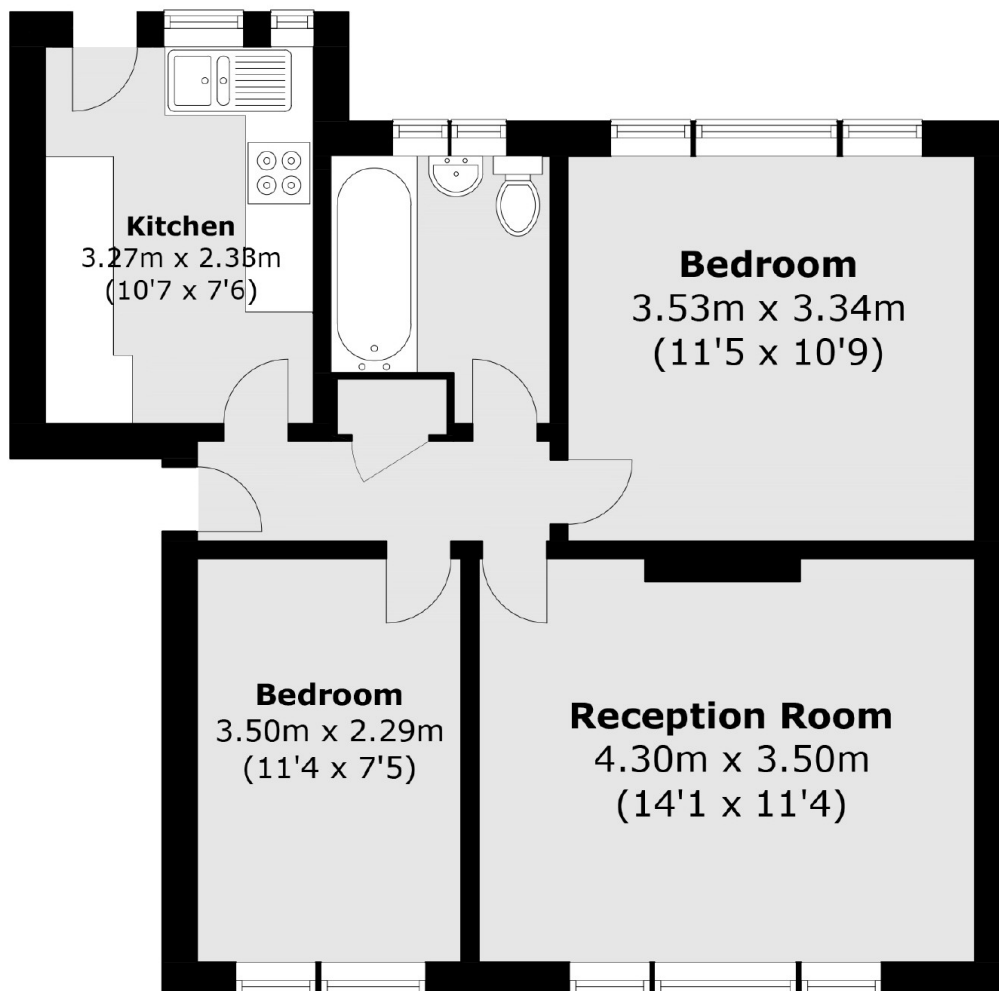

Total area (approx.): 52.3 sq. m (562.9 sq. ft)