



Lincoln Avenue, TW2

£600,000

Offered with no onward chain and backing onto Crane Park is this spacious three bedroom 1930's house that could be a wonderful family home for years to come. The property benefits from having potential to extend, off street parking to the front and a garage to the rear.

Lincoln Avenue is a fantastic residential street in a popular area of Twickenham. The property is close to Kneller Gardens Park, the River Thames and Whitton mainline station with its fast trains into London Waterloo. There are excellent state and private schools nearby (eg. Waldegrave Girls, Archdeacon, St. James and The Mall), two royal parks and many pleasant, green open spaces.

Features

- Three Bedrooms
- No Onward Chain
- Off Street Parking
- Garage
- Backing Onto Crane Park
- Potential To Extend The Loft & Rear

Lincoln Avenue, Twickenham, TW2

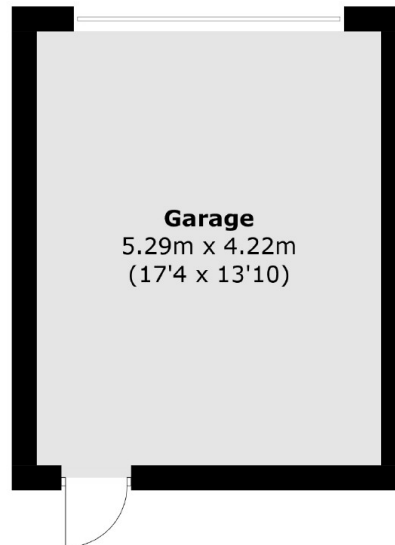

(Not Shown In Actual
Location / Orientation)

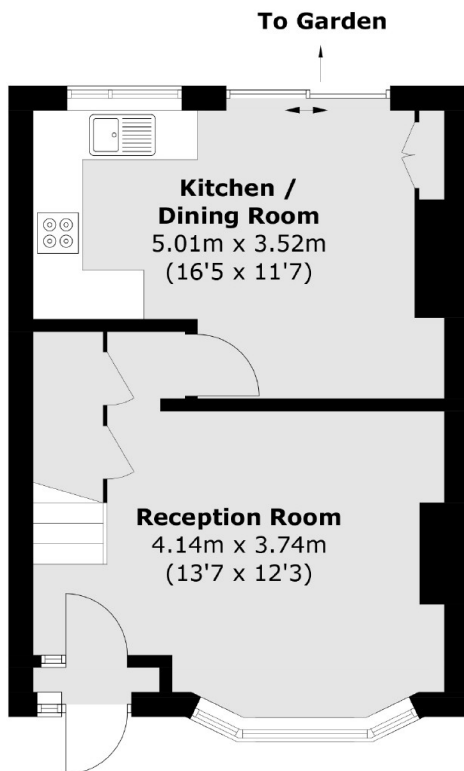

Ground Floor

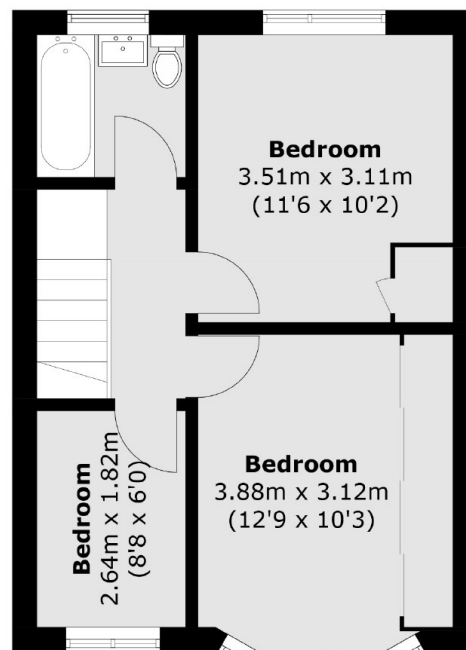

First Floor

Total area (approx.): 74.0 sq. m (796.5 sq. ft)
Garage: 22.4 sq. m (241.1 sq. ft)