



## Powder Mill Lane, TW2

£825,000

This impressive semi-detached six bedroom family home is a must view. Off street parking to the front, a lovely South West facing garden and an annex to the side with it's own bedroom and bathroom is perfect for someone requiring single story living or wanting to Air BNB for income.

Powder Mill Lane is located close to Crane Park nature reserve and leads to Whitton town centre where you will find a vast array of shops, café's and restaurants. There are also excellent bus routes in and out of Hounslow, Whitton and Twickenham as well as a fast link train to Waterloo from Whitton mainline station.

### Features

- Semi Detached House
- Six Bedrooms
- Two Bathrooms
- Off Street Parking
- Self Contained One Bedroom Annex

# Powder Mill Lane, Whitton, TW2

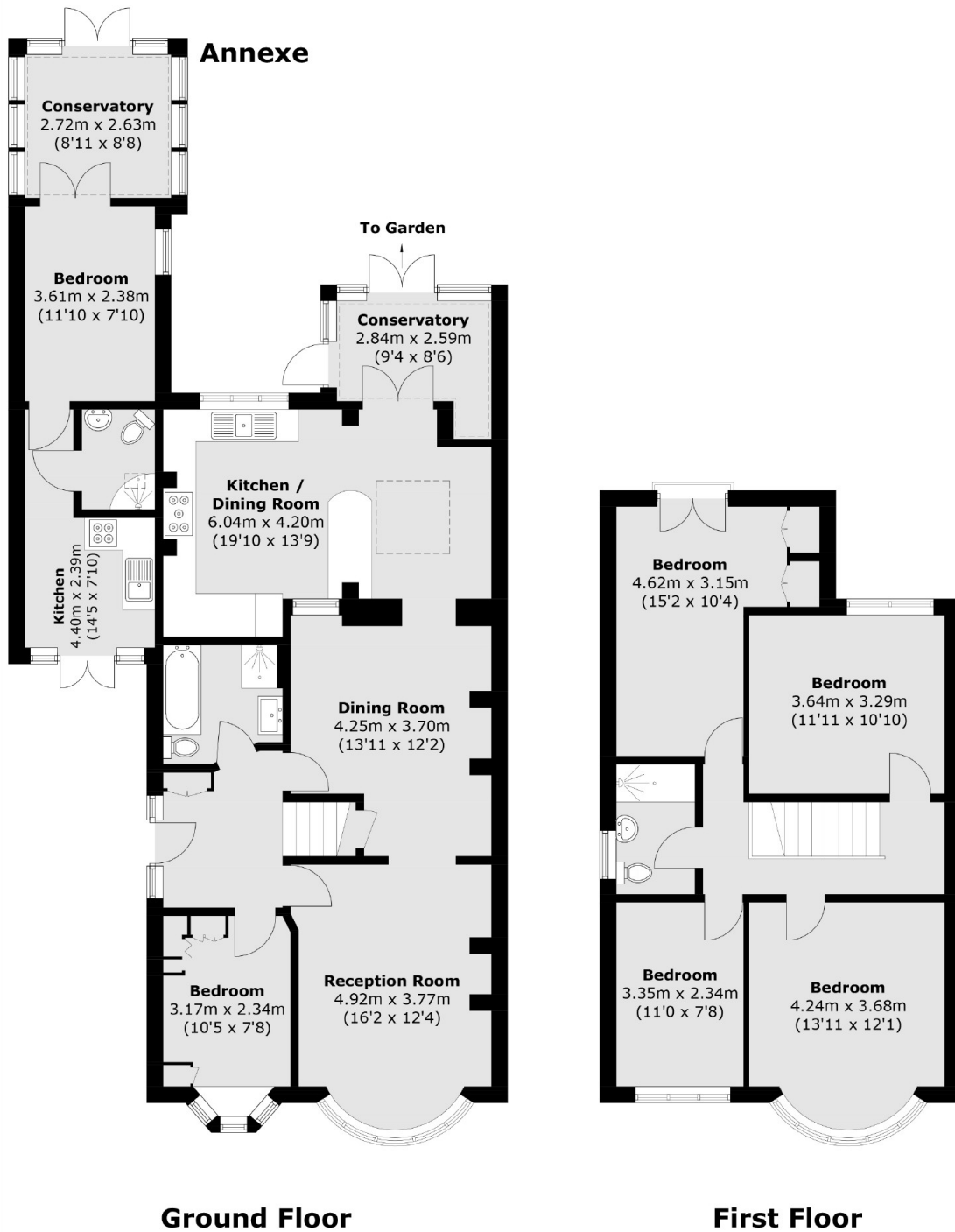

Total area (approx.): 145.0 sq. m (1,560.8 sq. ft)  
Annexe area (approx.): 27.4 sq. m (294.9 sq. ft)