



Fulwell Park Avenue, TW2

£580,000

Presented to the market for the first time in over 75 years and offered with no onward chain is this pretty three bedroom 1930's semi detached house. This could be a wonderful family home for a long time to come as it benefits from having generous potential to extend and also comes with a garage.

Fulwell Park Avenue is a quiet residential road close to an array of transport links which will take you to Twickenham, Richmond and Teddington high streets. Fulwell mainline station is just under a mile and the area is renowned for its excellent schools.

Features

- Three Bedrooms
- No Onward Chain
- Potential To Extend
- Popular Road
- Garage
- Pretty Private Garden

Fulwell Park Avenue, Twickenham, TW2

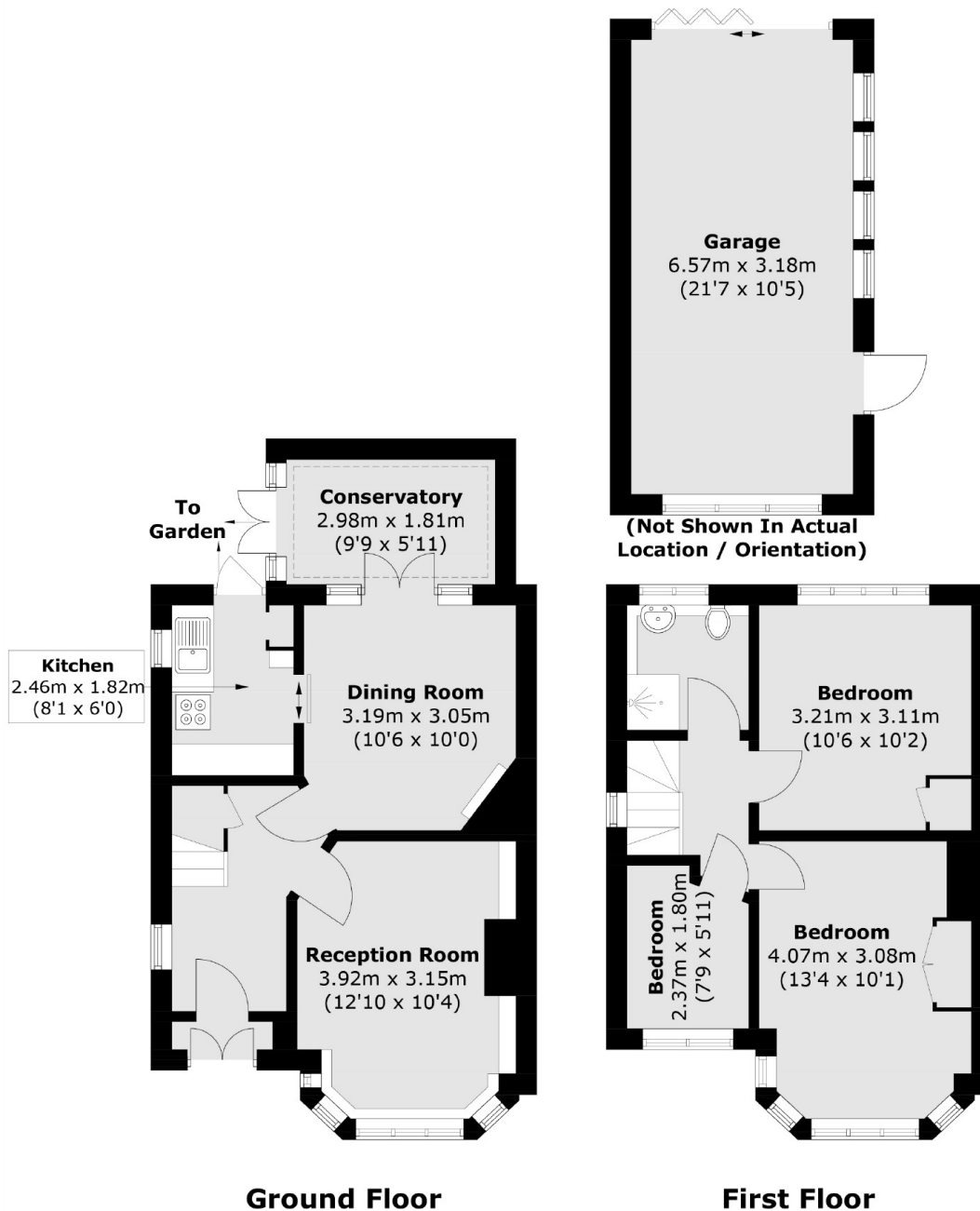

Total area (approx.): 74.4 sq. m (800.8 sq. ft)
Garage area (approx.): 21.5 sq. m (231.4 sq. ft)