



## Whitton Dene, TW7

£2,195 Per calendar month

This three bedroom semi-detached house in really good condition offers a large private garden, a well presented galley style kitchen, laminate wood flooring throughout and on street parking.

Whitton Dene is conveniently located for easy access to Hounslow, Whitton and Twickenham town centres, transport links and amenities.

### Features

- Three Bedrooms
- Two Reception Rooms
- Modern Kitchen
- New Bathroom
- Wood Laminate Flooring
- On Street Parking

# Whitton Dene, Isleworth, TW7

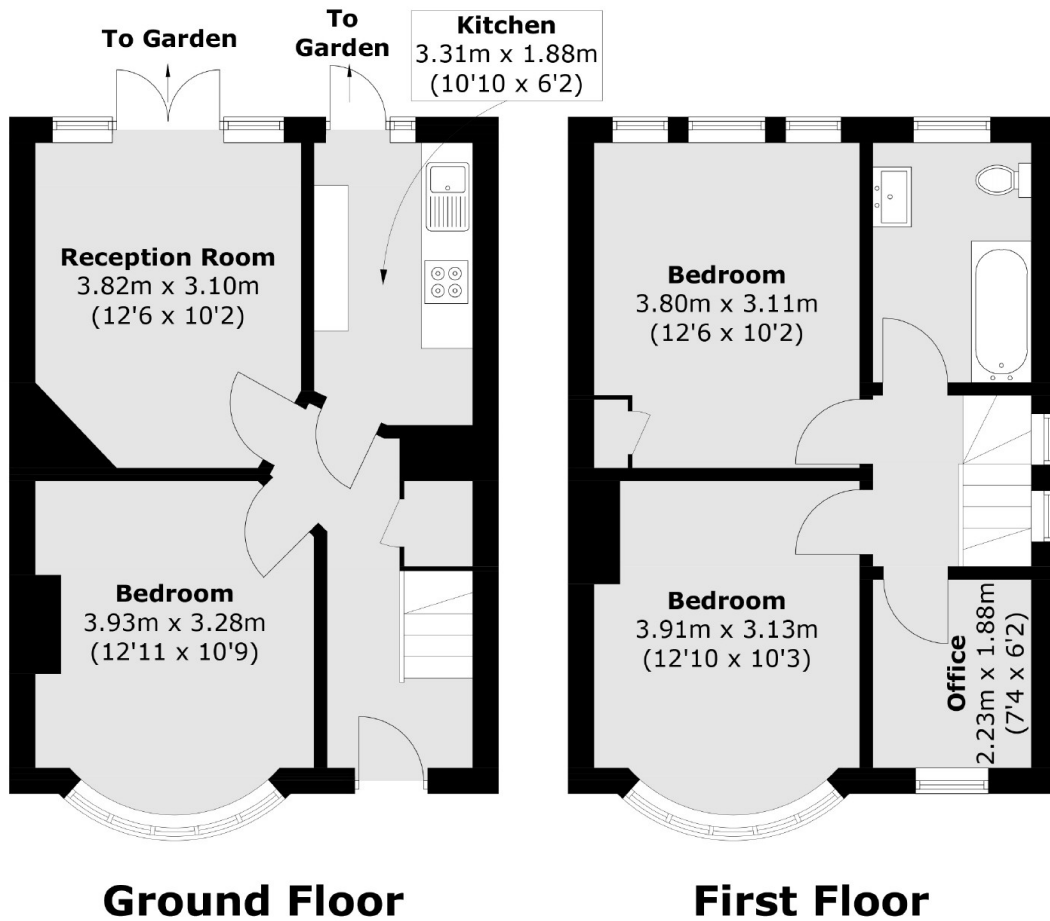

Total area (approx.): 76.8 sq. m (826.7 sq. ft)