



## Staines Road, TW2

£899,950

Offered with no onward chain and generous potential to extend into an incredible family home is this substantial three bedroom 1930's semi detached house that has a large garden measuring approx. 100ft in length, off street parking and a detached garage.

Staines Road offers convenient access in and out of Twickenham town centre where you will find a vast array of shops, pubs and restaurants. Both Twickenham and Strawberry Hill stations provide a link to London Waterloo and the area is renowned for some outstanding schools such as Waldegrave Girls, Archdeacon and Trafalgar.

### Features

- Three Bedrooms
- No Onward Chain
- Off Street Parking
- Detached Garage
- Large Garden Approx 100ft
- Potential To Extend The Rear & Loft

# Staines Road, Twickenham, TW2

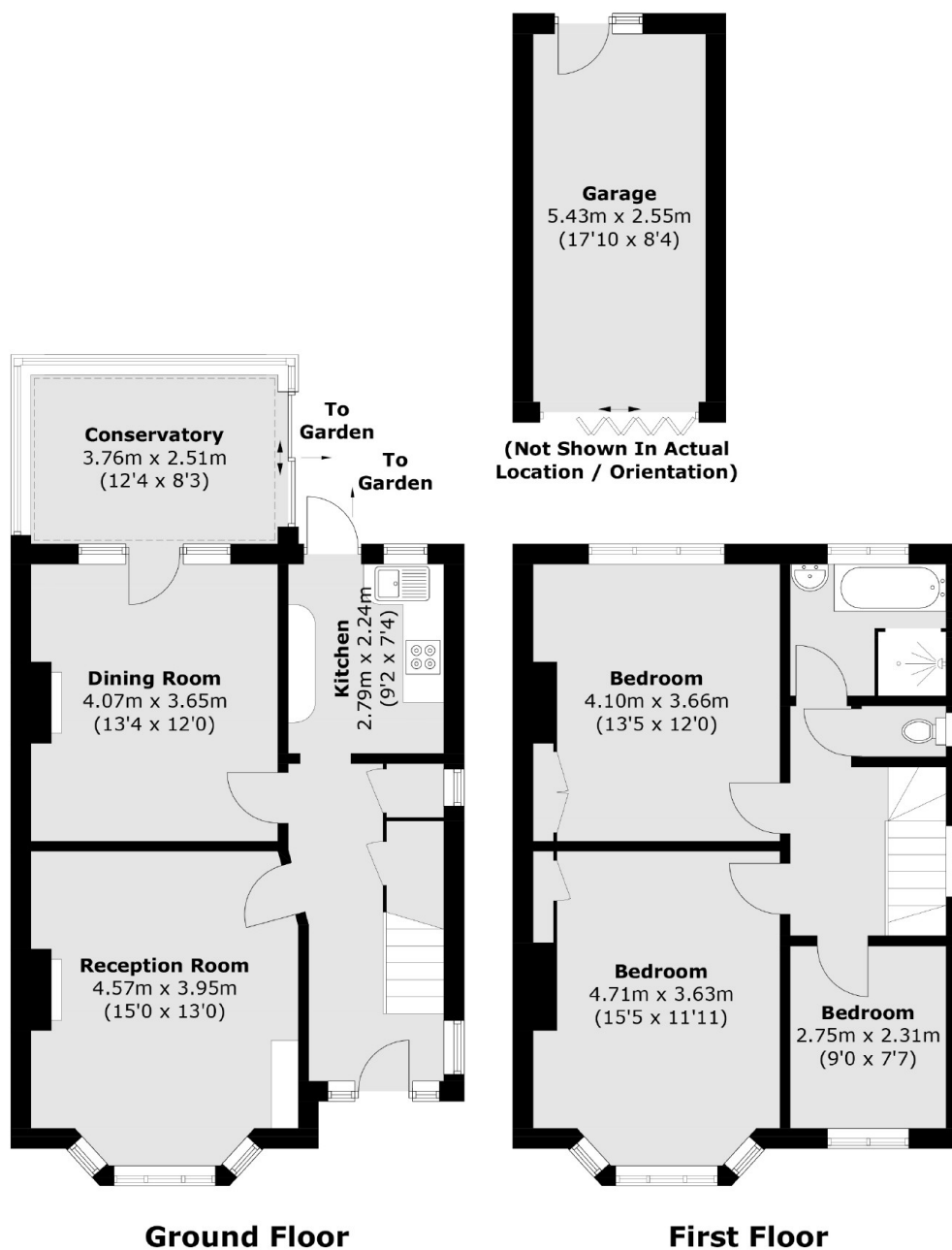

Total area (approx.): 113.5 sq. m (1,221.7 sq. ft)  
Garage (approx.): 14.4 sq. m (155.0 sq. ft)