



## Manor Road, TW2

### £330,000

Offered with no onward chain is this impressive two double bedroom flat situated in a popular development. The property benefits from having access to beautiful communal garden and residents parking as well as being in excellent condition throughout.

Manor Court is on Manor Road which is close to excellent schools such as Waldegrave Girls and Trafalgar. Twickenham Green and the high street is also less than a mile away which offers a wide variety of shops, pubs and restaurants.

### Features

- Two Double Bedrooms
- No Onward Chain
- Communal Gardens
- Residents Parking
- Excellent Condition
- Popular Development

# Manor Road, Twickenham, TW2

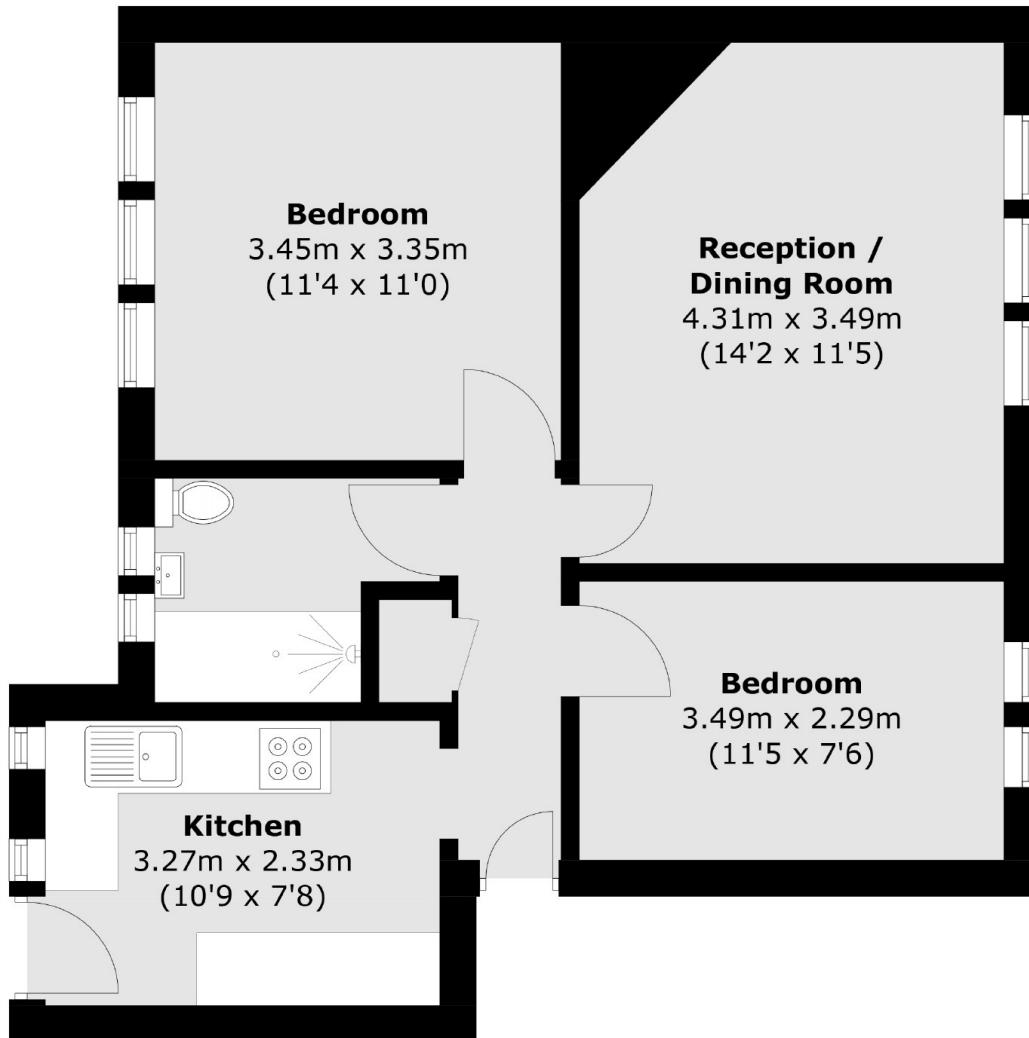

Total area (approx.): 52.4 sq. m (564 sq. ft)