



Latimer Road, TW11
£809,950

Dexters



Latimer Road, TW11

This stunning Victorian home is located in a quiet cul-de-sac close to Teddington High Street, the station and proximity to outstanding schools. A must view.

This home is presented in immaculate condition offering plenty of charm with a modern twist. The property has been cleverly extended to maximise the space on both the first and second floor. To the ground floor there is an impressive open plan kitchen/dining/reception room with skylights and bi-fold doors leading to the garden. Filled with natural light, it is a wonderful space for living and entertaining with modern units. Completing the ground floor there is a second reception room with period fireplace, a newly fitted bathroom and additional storage.

On the first floor, there are three double bedrooms which is rare for a home in this road. The garden is delightful and secluded with a patio and lawn with artificial grass useable all year around along with rear access.

Latimer Road is a turning off Church Road. An excellent location for schools, transport links, shops, bars and restaurants. Bushy Park and The River Thames are close by.

Features

- Three Double Bedrooms
- 23ft Kitchen/Living Room
- Further Reception Room
- Long Garden
- Rear Access
- End Of Terrace







Latimer Road,
Teddington, TW11

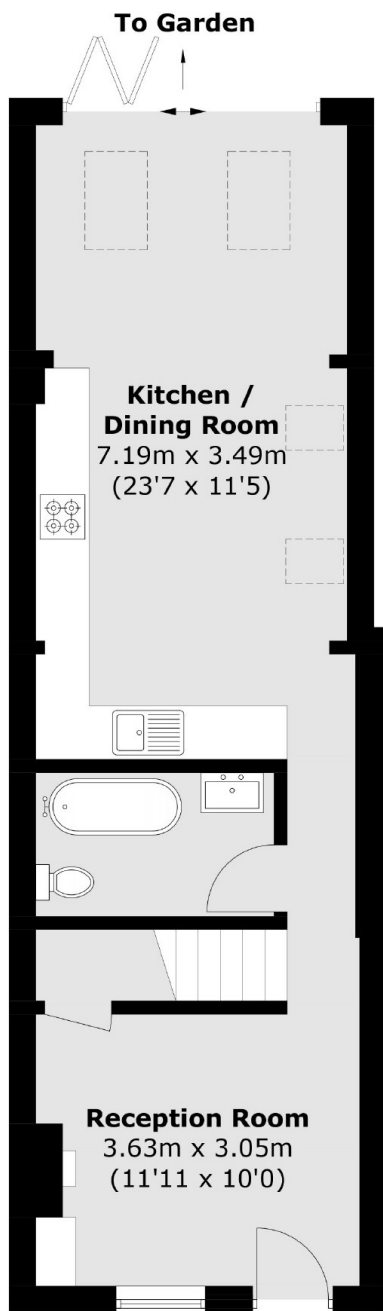

Ground Floor

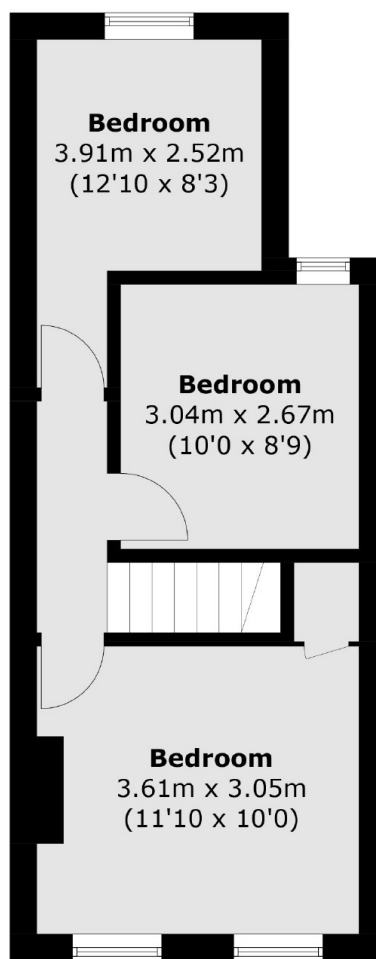

First Floor

Total area (approx.): 80.2 sq. m (863.3 sq. ft)