



## Walpole Place, TW11

£619,950

This pretty Victorian cottage is situated in a quiet centrally located cul-de-sac, a perfect location close to all local amenities. The property boasts two reception rooms and two double bedrooms.

Walpole Place is off Walpole Road, perfect for the High Street with its many shops, bars and restaurants. The River Thames is close by and so is Bushy Park.

### Features

- Excellent Decorative Order
- Central Location
- Two Double Bedrooms
- Two Reception Rooms
- Private Garden
- Close To Shops And Transport

# Walpole Place, Teddington, TW11

## Ground Floor

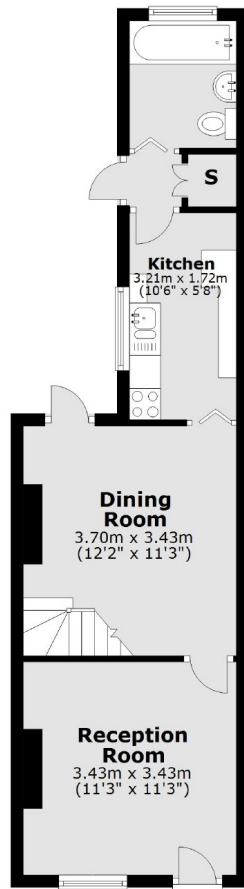

## First Floor

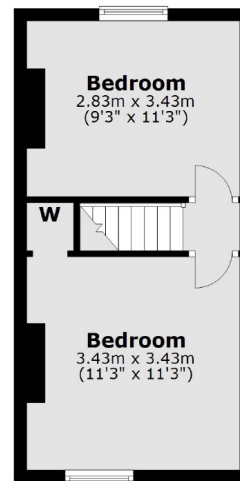

Total area: approx. 60.6 sq. metres (652.4 sq. feet)