



## Harrowdene Gardens, TW11

£1,495 Per calendar month

This recently refurbished top floor apartment is ideally located in a sought-after development close to Bushy Park and less than 0.5 miles to Teddington train station.

The Harrowdene Gardens development has its own communal gardens and is 0.4 miles from the picturesque Bushy Park. Teddington mainline station and the high street with restaurants, local pubs and boutique shops are also close by.

### Features

- One Double Bedroom
- Recently Redecorated
- Ample Storage Throughout
- Excellent Location
- Communal Gardens
- Popular Development

# Harrowdene Gardens, Teddington, TW11

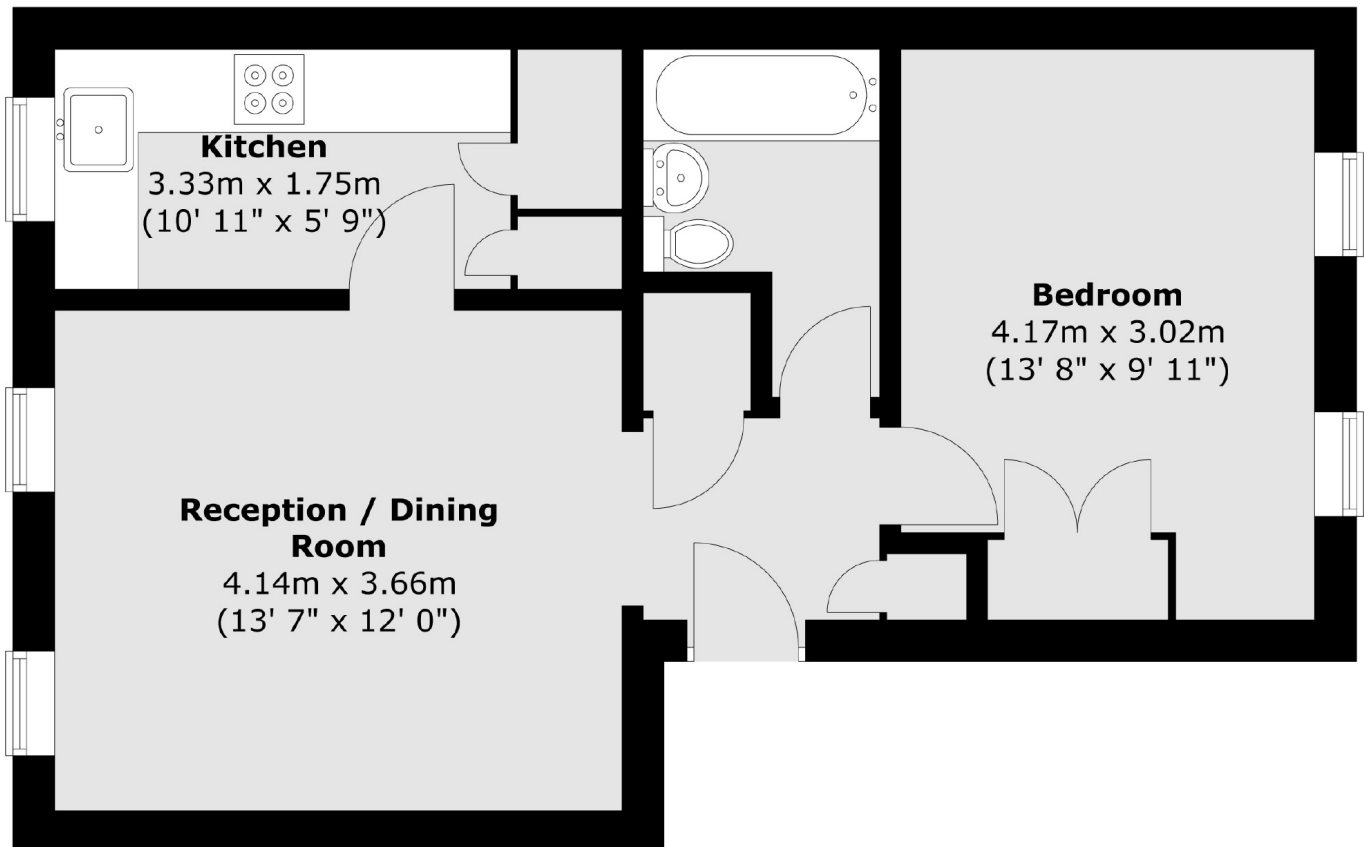

Total area (approx.) : 44.2 sq. m (476 sq. ft)