



## Waldegrave Road, TW11

£365,000

Welcome to this charming two bedroom first floor flat located on the sought-after Waldegrave Road in Teddington. This well presented property offers a comfortable and convenient living space, perfect for individuals or small families.

Situated on Waldegrave Road, this flat is ideally located for easy access to the amenities and attractions of Teddington. The area offers a range of shops, cafes and restaurants as well as excellent transport links including Teddington Station just a short walk away.

### Features

- First Floor Apartment
- Two Bedrooms
- Allocated Parking
- Excellent Location
- Well Presented
- School Catchment



## Waldegrave Road, TW11

Upon entering the flat, you are greeted by a spacious and bright open plan living and dining area. The large windows allow an abundance of natural light to fill the room, creating a warm and inviting atmosphere. The neutral decor and modern finishes give the space a contemporary feel. The fully fitted kitchen is conveniently situated adjacent to the living area, making it ideal for entertaining guests. It features ample storage space, sleek counter tops, and modern appliances.

The flat boasts two generously sized bedrooms, both offering plenty of space for relaxation and rest. Both double bedrooms benefit from large windows allowing in plenty of natural light. One of the standout features of this property is the allocated parking space providing convenience. Overall, this two bedroom first floor flat on Waldegrave Road offers a fantastic opportunity to enjoy comfortable and convenient living in the heart of Teddington. Don't miss out on the chance to make this wonderful property your new home.





# Waldegrave Road, Teddington, TW11

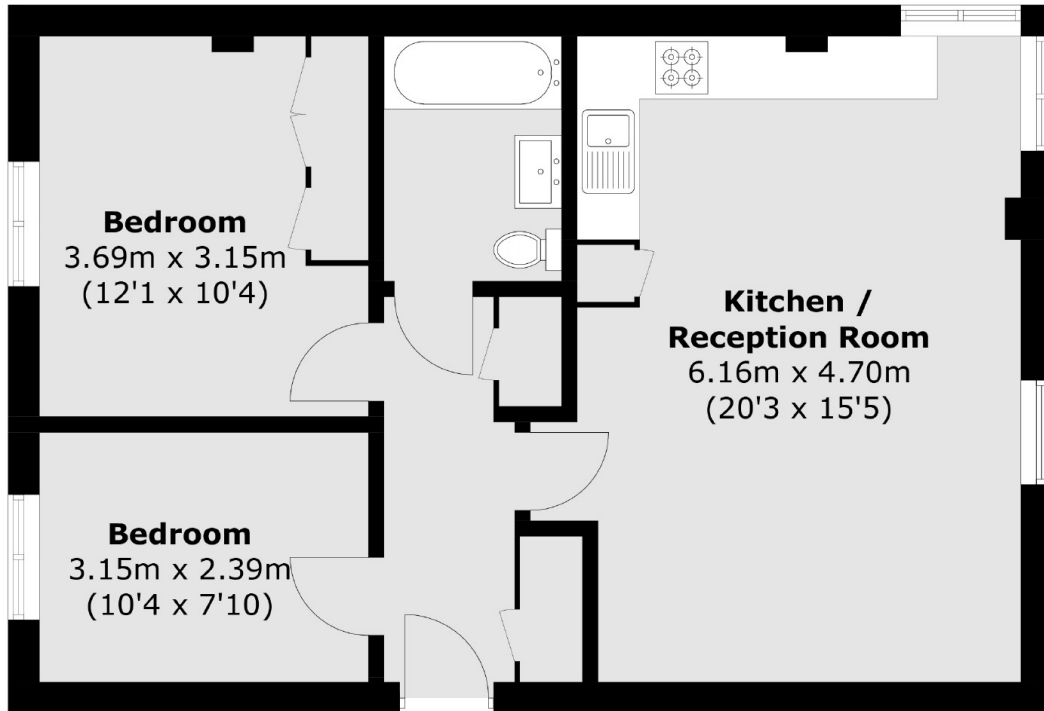

## Second Floor

Total area (approx.): 58.4 sq. m (628.6 sq. ft)