



## Gloucester Road, TW11

£474,950

A delightful two double bedroom raised ground floor apartment with private parking, forming the main hall-floor of an elegant Victorian mansion house built circa 1891, newly converted in 2016 to provide outstanding period accommodation. The flat boasts charming Victorian features, including high ceilings that provide a stunning wow factor, French-style shutters, and has been well looked after. It is in excellent decorative order throughout and benefits from allocated parking, communal gardens, and a long lease.

Gloucester Road is a premier road located in the heart of Teddington, close to Teddington mainline station, Teddington High Street, and the River Thames. Bushy Park, just a 10-minute walk away, is also within easy reach and the area of Teddington makes this an excellent spot for schools.

### Features

- Allocated Parking
- Original Features
- Excellent Condition
- Communal Garden
- Long Lease
- Two Double Bedrooms

# Gloucester Road, Teddington, TW11

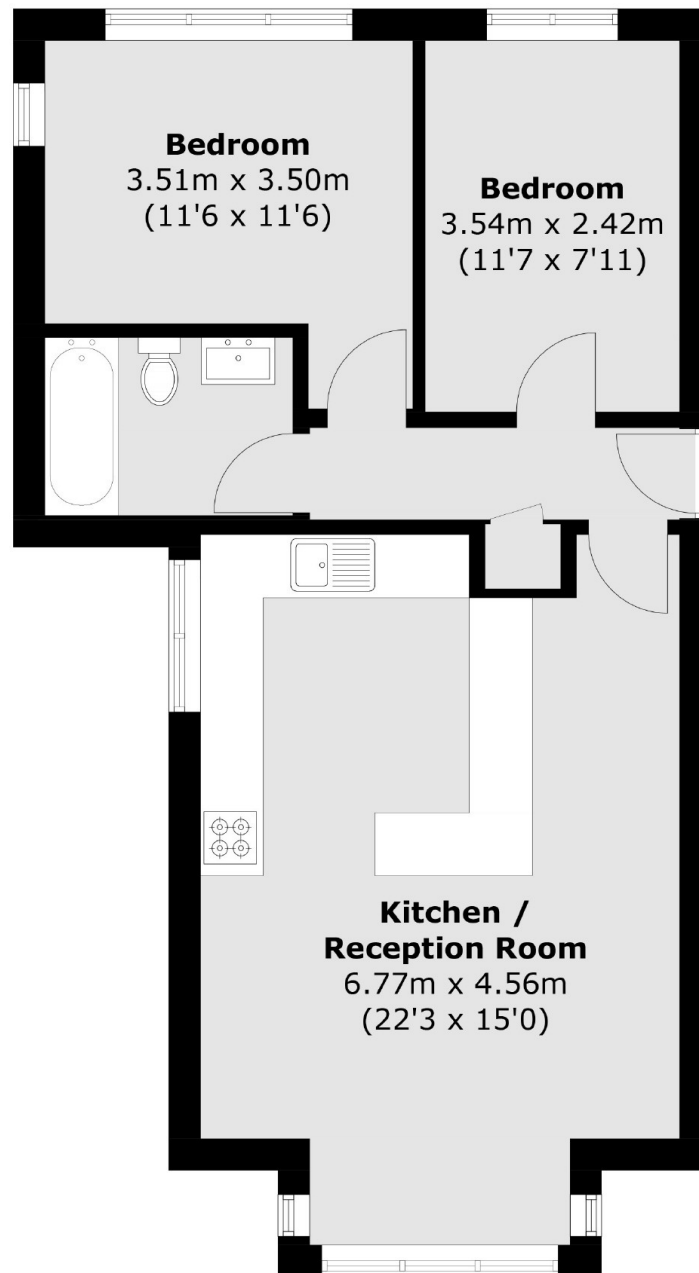

Total area (approx.): 57.1 sq. m (614.6 sq. ft)