



Gloucester Road, TW11

£514,950

A delightful two double bedroom raised ground floor apartment with private parking, communal gardens and a long lease. Gloucester Road is a premier road located in the heart of Teddington.

Gloucester Road is a premier road located in the heart of Teddington, close to Teddington mainline station, Teddington High Street, and the River Thames. Bushy Park, just a 10-minute walk away, is also within easy reach and the area of Teddington makes this an excellent spot for schools.

Features

- Allocated Parking
- Original Features
- Excellent Condition
- Communal Garden
- Long Lease
- Two Double Bedrooms



Gloucester Road, TW11

Located in the main hall-floor of an elegant Victorian mansion house built circa 1891 and newly converted in 2016 to provide outstanding period accommodation. The flat boasts charming Victorian features, including high ceilings that provide a stunning wow factor, French-style shutters, and has been well looked after. There are two double bedrooms with rear views of the garden and a bathroom. It is in excellent decorative order throughout and benefits from allocated parking, communal gardens, and a long lease.



Gloucester Road, Teddington, TW11

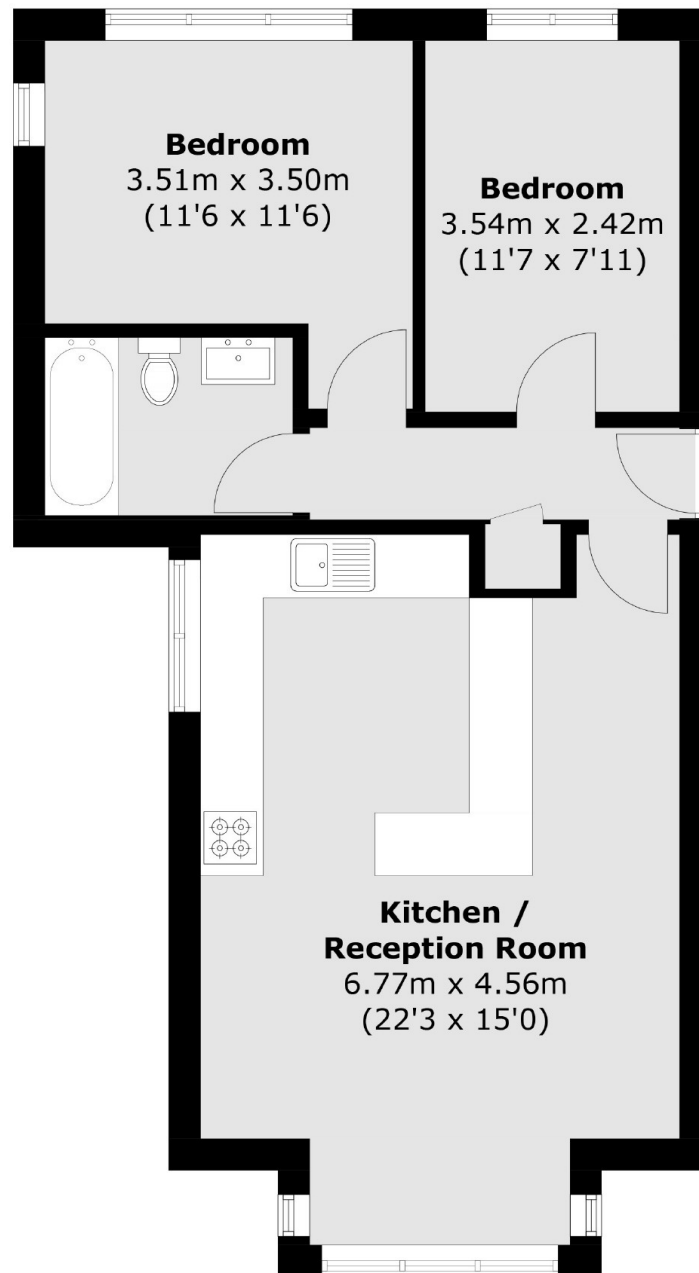

Total area (approx.): 57.1 sq. m (614.6 sq. ft)