



## Bridgeman Road, TW11

£1,995 Per calendar month

A beautifully presented first floor apartment in the centre of Teddington, Churcham House was recently converted to high spec apartments. The apartment has wooden flooring, a modern kitchen with integrated appliances, and plantation shutters.

Bridgeman Road is located off of Station Road, less than 200 yards to Teddington train station and the High Street. With its selection of local shops, it's only a short walk home from some of the best pubs in the area.

### Features

- High Spec Fittings
- Plantation Shutters
- Central Location
- Ample Built In Storage
- Recently Converted
- Large Open Plan Living

# Bridgeman Road, Teddington, TW11

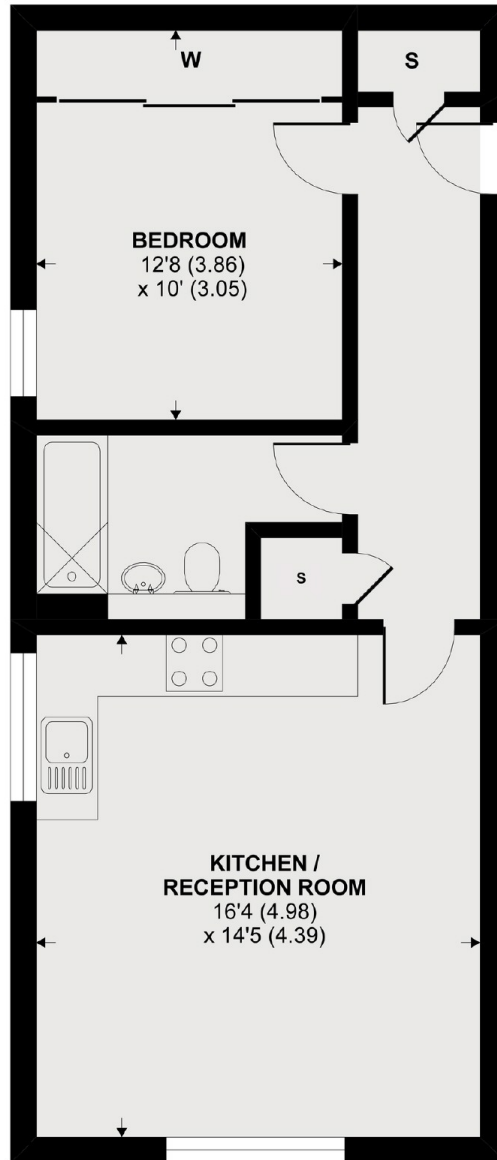

1st Floor

APPROX FLOOR AREA: 321 SQ FT 29.4 SQ M  
© Copyright iStockphoto.com.uk 2020 REF: 554257

# Dexters

Teddington  
61 High Street  
Teddington  
TW11 8HA  
Lettings  
020 8288 2900

Energy Rating: C. We aim to make our particulars both accurate and reliable. However they are not guaranteed; nor do they form part of an offer or contract. If you require clarification on any points then please contact us, especially if you're traveling some distance to view. Please note that appliances and heating systems have not been tested and therefore no warranties can be given as to their good working order.

 **RICS** | Regulated  
Estate Agent  
and Letting Agent

dexters.co.uk