



Fairfax Road, TW11

£719,950

Located in one of Teddington's favoured roads within catchment for outstanding primary schools this home has a large amount of potential to create the home of your dreams.

Currently the layout of this well loved family home offers two separate reception rooms, a galley kitchen and bathroom to the ground floor. Accessed from the kitchen is the garden which is secluded and laid to lawn. There are three bedrooms to the first floor.

There are plenty of possible options with this home should you decide to extend now or in the future. The ground floor could be extended to the side and rear along with additional extension into the loft all STPP.

Fairfax Road is a turning off Cromwell Road. Close to Teddington High Street with shops, bars and restaurants and Teddington mainline station. The River Thames, Bushy Park and Kingston shopping centre

Features

- Three Bedrooms
- Excellent Location
- Victorian
- Secluded Garden
- Plenty Of Potential
- Good School Catchment

Fairfax Road, Teddington, TW11

Ground Floor

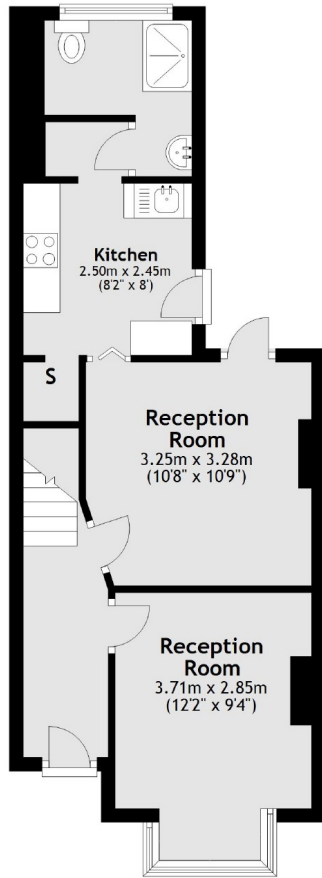

First Floor

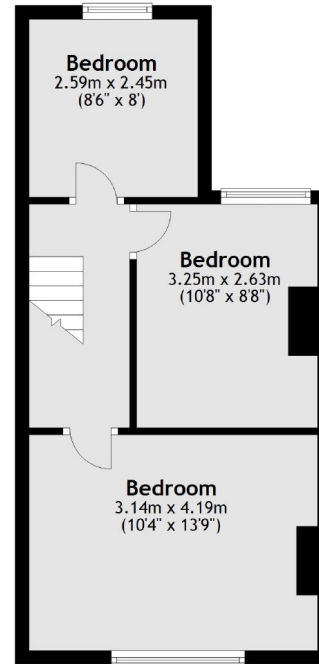

Total area: approx. 73.1 sq. metres (787.2 sq. feet)