



Claremont Gardens, KT6

£375,000

A stunning two bedroom first floor conversion flat that is immaculately presented throughout. There is a large reception room, master bedroom, second double bedroom and main bathroom. The property also benefits from a share of the freehold.

Situated in one of Surbiton's most sought after tree lined roads, within ½ a mile of Surbiton town centre and mainline station. The area also has a vast selection of shops, bars and restaurants with the River Thames and Kingston town centre being within a mile radius.

Features

- Period Conversion Flat
- Two Double Bedrooms
- Share of Freehold
- Central Location
- Open Plan
- Permit Parking

Claremont Gardens, Surbiton, KT6

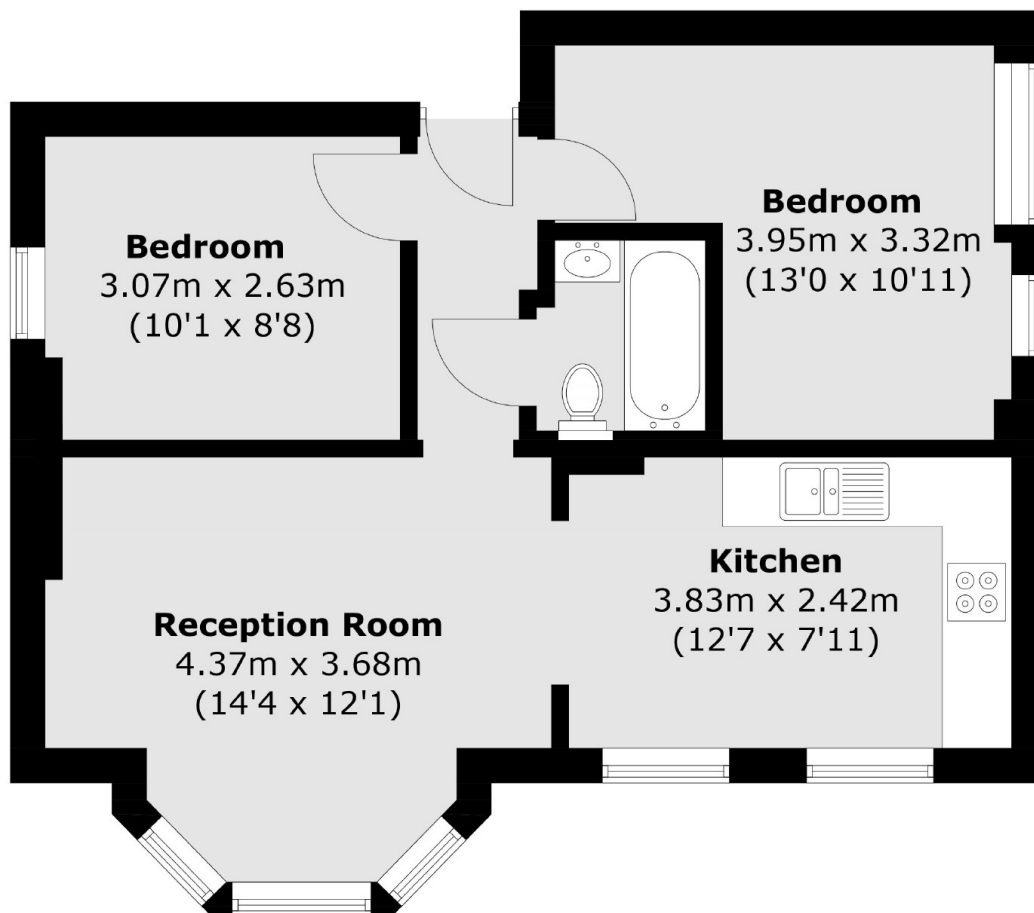

Total area (approx.): 50.2 sq. m (540.3 sq. ft)