



Hook Road, KT6

£475,000

A simply stunning, two double bedroom garden flat. Situated within an imposing 1930's purpose built development, this apartment is immaculate throughout, it has a large living/dining room with an exposed brick fireplace and woodburner, the smart kitchen is integrated and the bedrooms are bright and beautifully presented. There is a private garden accessed via the kitchen and a home office for extra space.

Malvern Court is conveniently located with Surbiton's bars and restaurants and its train station with fast links to London Waterloo under a mile away. There are nearby bus routes and convenient access to the A3.

Features

- Ground Floor
- Two Double Bedrooms
- Private Garden
- Home Office
- Immaculate Throughout
- Convenient Location

Hook Road, Surbiton, KT6

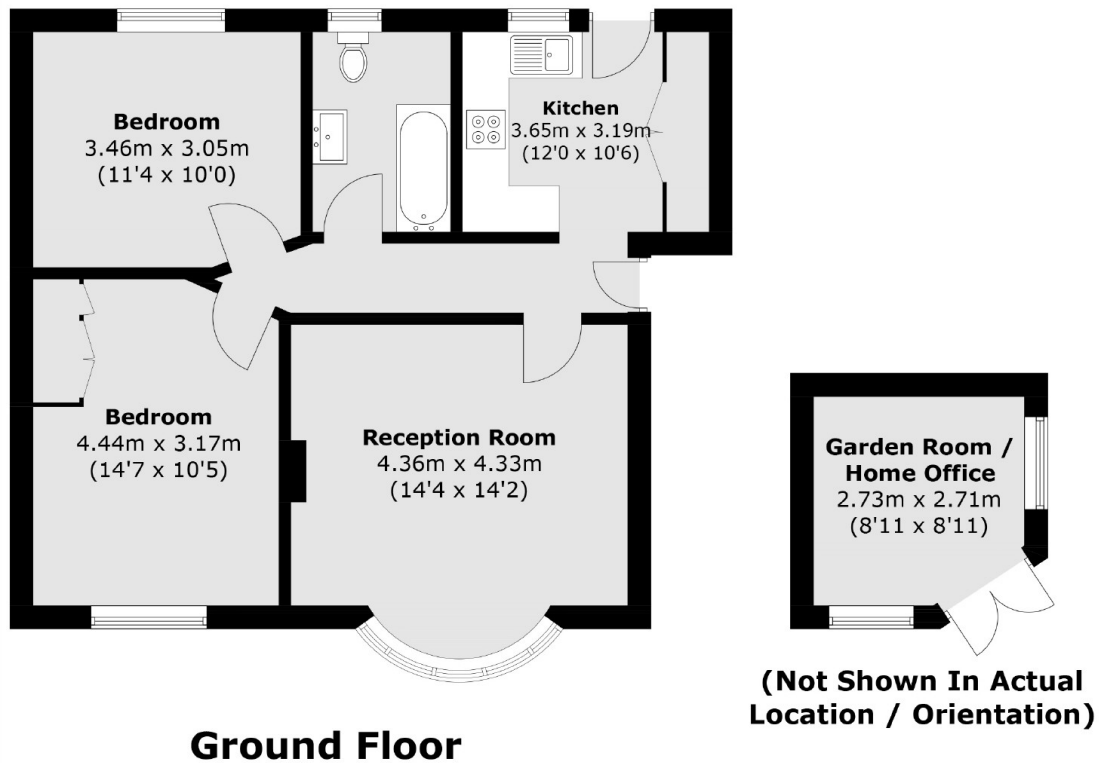

Total area (approx.): 61.2 sq. m (658.7 sq. ft)
Garden Room / Home Office : 7.1 sq. m (76.4 sq. ft)