



Ferry Road, KT7

£550,000

This two bedroom period cottage is on an idyllic River Road in Thames Ditton. The ground floor offers plenty of living space and has a large reception room, a W.C, and a large modern kitchen/diner to the rear of the property with direct access onto the garden. Upstairs there are two double bedrooms and a family bathroom.

Ferry Road is a quiet residential road in Thames Ditton. It is conveniently located between Thames Ditton and Surbiton with both of there trainlines, restaurants and amenities. Surbiton station has a fast train to Waterloo and the A3 is close by offering easy motor access into London.

Features

- Two Double Bedrooms
- Modern interior
- Period Features
- Open Plan
- Riverside Location
- Private Garden

Ferry Road, Thames Ditton, KT7

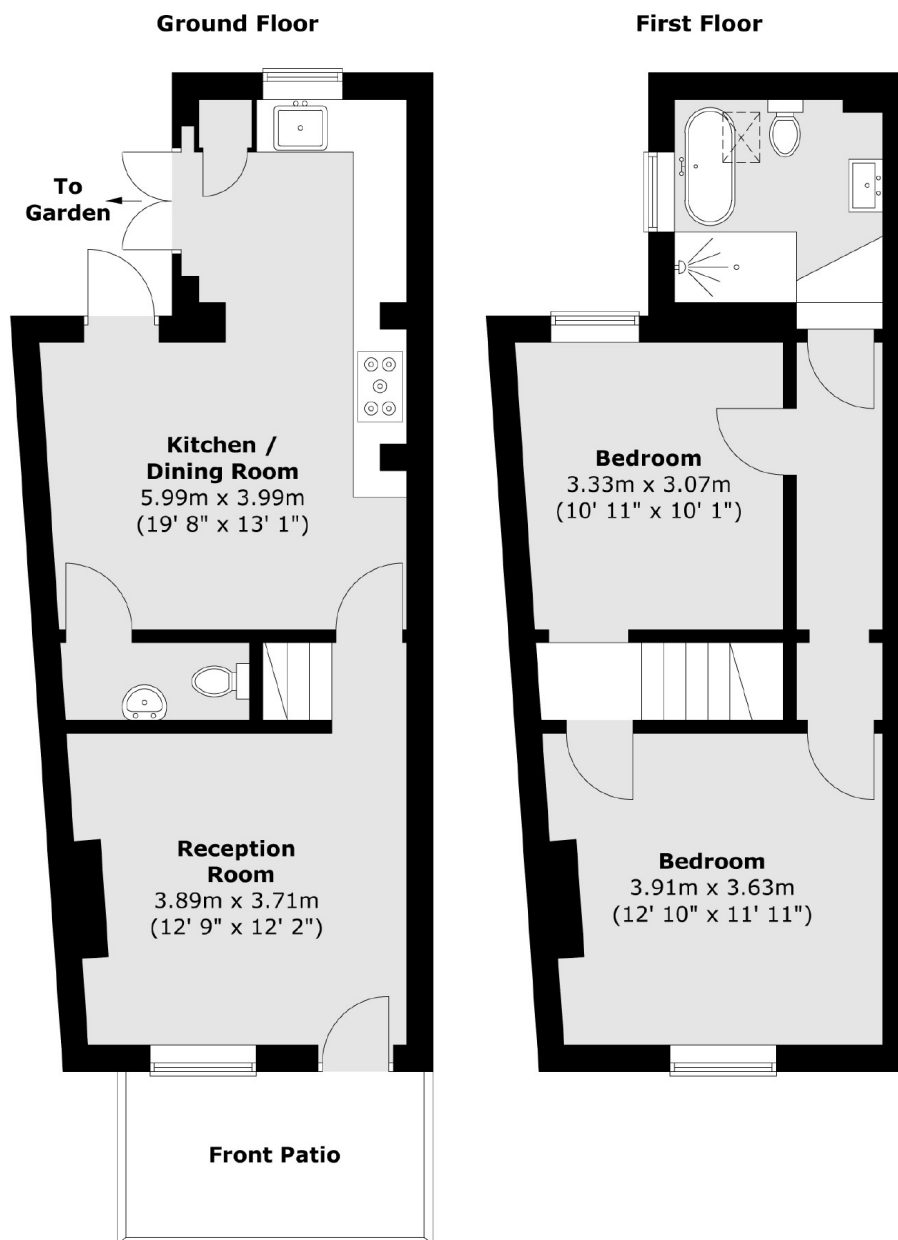

Total area (approx.) : 77.8 sq. m (837 sq. ft)
Total front patio area (approx.) : 4.9 sq. m (53 sq. ft)