



Barnsbury Crescent, KT5

£450,000

This terraced family home is offered to the market with no onward chain and includes a through reception/dining room, a separate kitchen, three bedrooms and a private rear garden. There is also scope to modernise throughout and space to extend on the ground floor (STPP).

Barnsbury Crescent is conveniently less than half a mile away from Tolworth train station and a selection of local shops, bars and restaurants. There is also easy access to the A3.

Features

- Terraced Family Home
- Double Reception/Dining Room
- Separate Kitchen
- Three Bedrooms
- Large Garden
- Scope To Extend (STPP)

Barnsbury Crescent, Surbiton, KT5

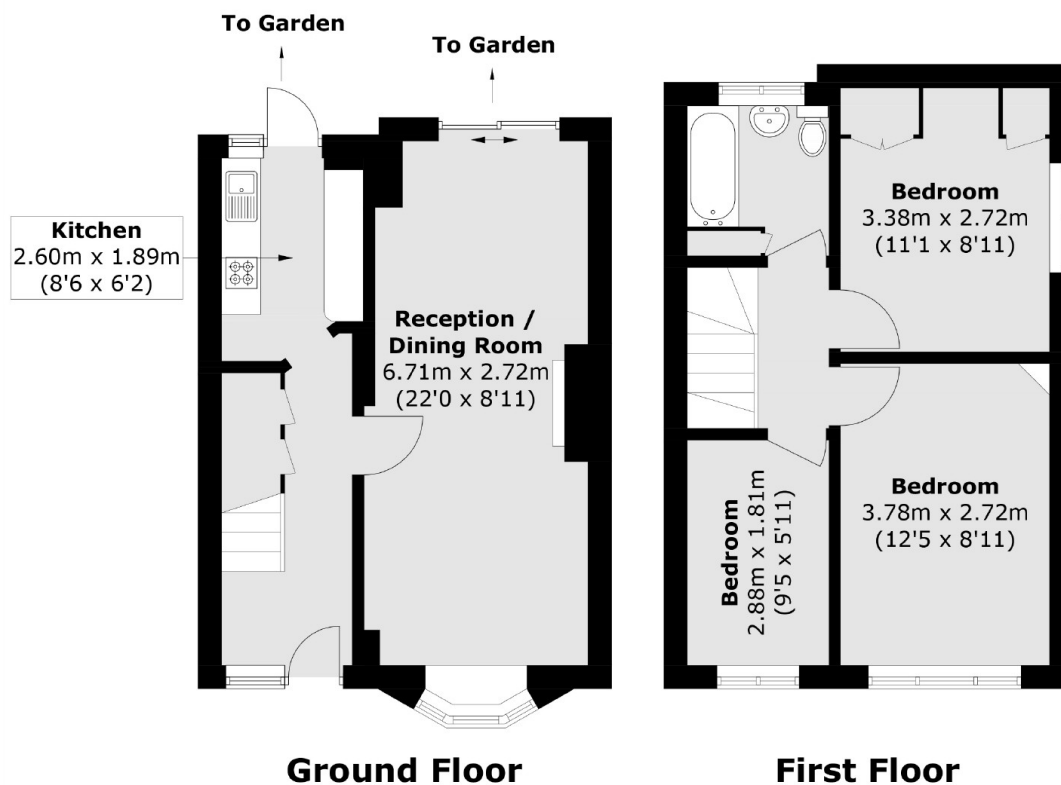

Total area (approx.): 65.1 sq. m (700.7 sq. ft)