



King Charles Road, KT5

£270,000

This spacious one bedroom period conversion flat is offered to the market with no onward chain. There is an open reception/kitchen/dining space with a large double bedroom and big bathroom that is all in good condition. This property also benefits from a communal garden.

King Charles Road is less than a mile away from Surbiton town centre with its shops, bars restaurants and station with its fast links into Waterloo. The property is near Surbiton's Fishponds and around the corner from Alexandra Park.

Features

- One Double Bedroom
- Period Property
- Great Location
- Communal Garden
- Share of Freehold
- No Onward Chain

King Charles Road, Surbiton, KT5

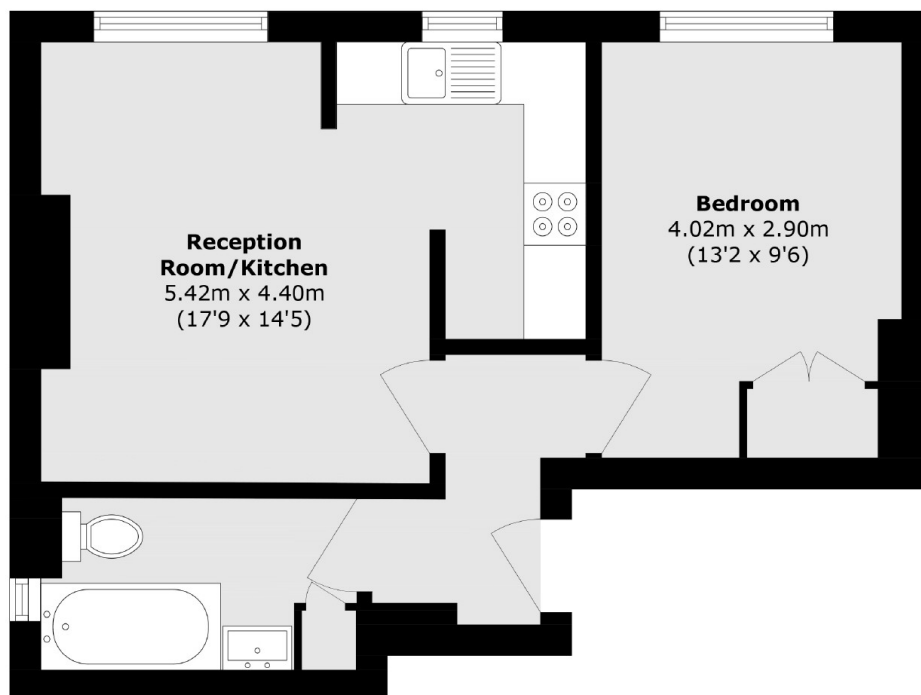

Total area (approx.): 42.5 sq. m (457.4 sq. ft)

Dexters

Surbiton
2 Claremont Road
Surbiton
KT6 4QU
Sales
020 8390 3939

Energy Rating: C. We aim to make our particulars both accurate and reliable. However they are not guaranteed; nor do they form part of an offer or contract. If you require clarification on any points then please contact us, especially if you're traveling some distance to view. Please note that appliances and heating systems have not been tested and therefore no warranties can be given as to their good working order.

 **RICS** | Regulated
Estate Agent
and Letting Agent

[dexters.co.uk](https://www.dexters.co.uk)