

Avenue Elmers, KT6

£475,000

A bright and spacious apartment in a central Surbiton location offered with no onward chain. This fantastic flat has two double bedrooms, two bathrooms, a private balcony and off-street parking for residents and visitors.

Avenue Elmers is approximately half a mile away from everything you need, including the River Thames, the desirable Maple Road, Surbiton high street and the mainline train station.

Features

- Two Bedrooms
- Two Bathrooms
- Private Balcony
- Off-Street Parking
- No Onward Chain
- Central Location

Avenue Elmers, Surbiton, KT6

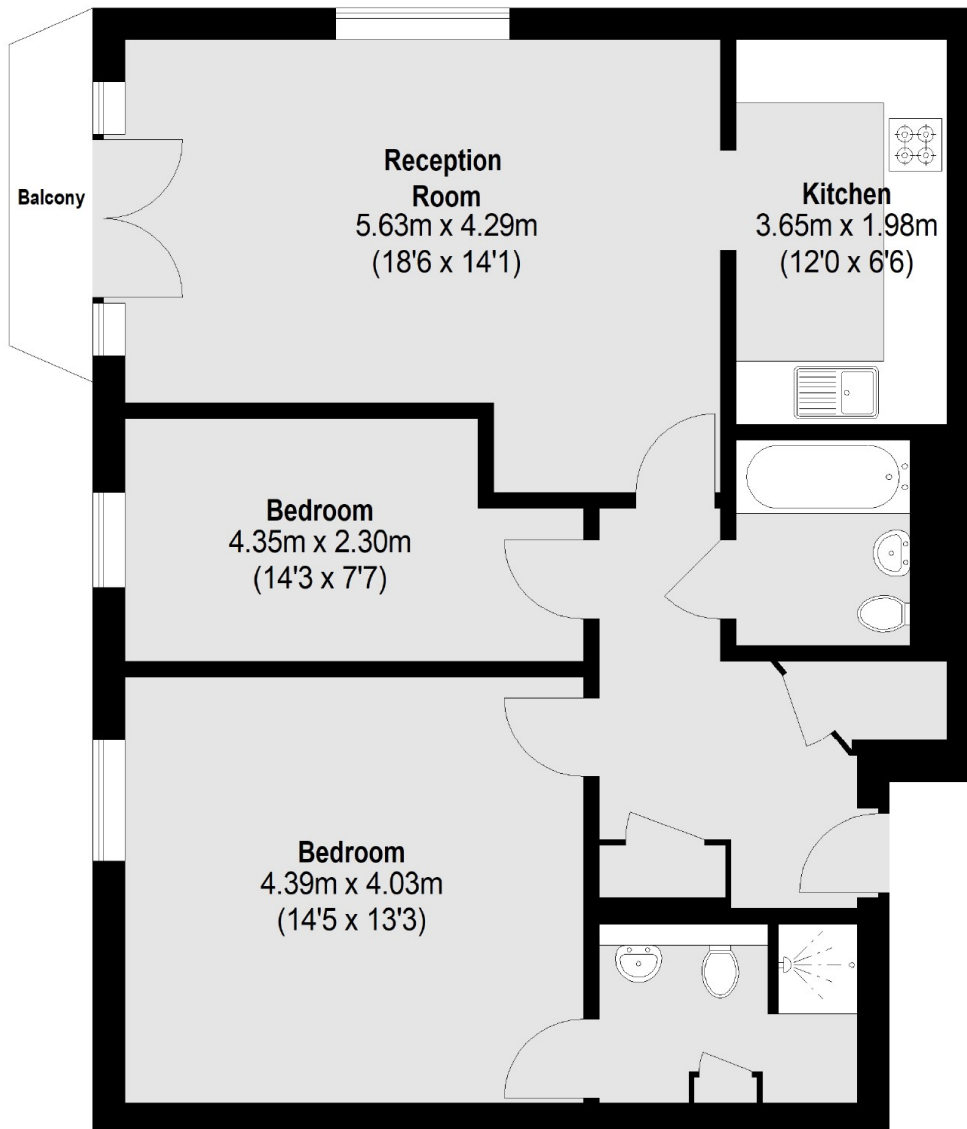

Total area (approx.): 76.34 sq. m (822 Sq. ft)
Balcony: 2.56 sq. m (28 Sq. ft)