



Surbiton Hill Road, KT6

£500,000

A ground floor Victorian conversion with period features and high ceilings. There is a private entrance that opens onto the kitchen/dining/living room. Off one double bedroom there are french doors that open onto the private garden. There is a large principal bedroom with huge bay windows with a family bathroom just down the corridor.

Ideally located between Surbiton and Kingston town centres in an area with popular shops, restaurants and bars and a frequent bus service. Both the River Thames and Surbiton station are within 0.6 miles.

Features

- Victorian Conversion
- Private Entrance
- Two Double Bedrooms
- Private Garden
- Share of Freehold
- No Chain

Surbiton Hill Road, Surbiton, KT6

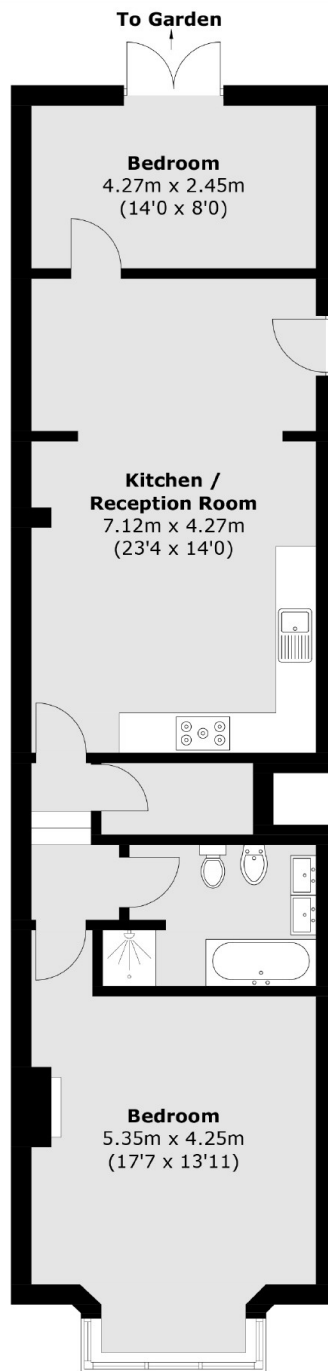

Ground Floor

Total area (approx.): 76.9 sq. m (827.7 sq. ft)