



Glenbuck Road, KT6

£325,000

A wonderful, newly refurbished one bedroom maisonette. With a private garden and parking to the front, plus four guest parking spaces behind, this property is ideal for access to Surbiton station and high street. A perfect first time buy, bolt hole or buy to let.

Conveniently located next to the train station with its quick links in to London Waterloo (17 mins), Glenbuck Road is ideal for the regular commuter or a city lover, the bars, restaurants and farmers market of Maple Road and Victoria Road are also nearby

Features

- Maisonette
- One Bedroom
- Garden/Shed
- Off Street Parking
- Convenient Location
- Newly Refurbished

Glenbuck Road, Surbiton, KT6

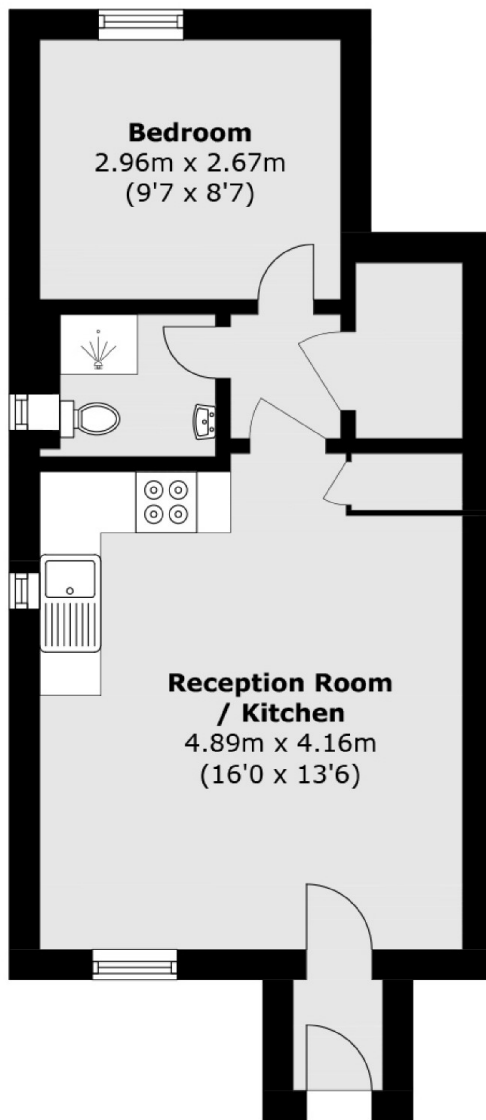

Total area (approx.): 35.8 sq. m (385.3 sq. ft)