



Egmont Road, KT6

£599,950

With three bedrooms, two reception rooms and a lovely private rear garden, this period property offers the perfect amount of space for a family to live comfortably. This property also has potential to extend and add further value (STPP).

A quiet and peaceful road, Egmont Road is under a mile away from both Tolworth and Surbiton mainline train stations with their quick links to London Waterloo.

Features

- Period Property
- Semi Detached
- Two Reception Rooms
- Three Bedrooms
- Scope to Extend (STPP)
- No Onward Chain

Egmont Road, Surbiton, KT6



Ground Floor

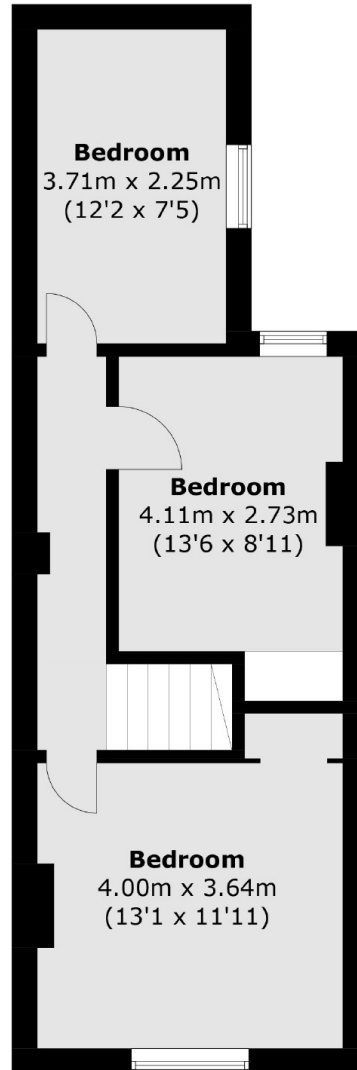

First Floor

Total area (approx.): 86 sq. m (925.7 sq. ft)