



Ewell Road, KT6

£299,950

A spacious ground floor flat with a reception room with access to a private garden, kitchen with integrated appliances, double bedroom with built in storage and a bathroom. The property benefits from no onward chain.

Situated approximately $\frac{3}{4}$ of a mile from Surbiton's mainline station and busy high street, the area has a fantastic selection of shops, bars, restaurants and popular local parks. There is an excellent local bus service and easy access to Kingston's town centre and the A3.

Features

- Ground Floor Flat
- Private Entrance
- One Double Bedroom
- Spacious Reception Room
- Private Garden
- No Chain

Ewell Road, Surbiton, KT6

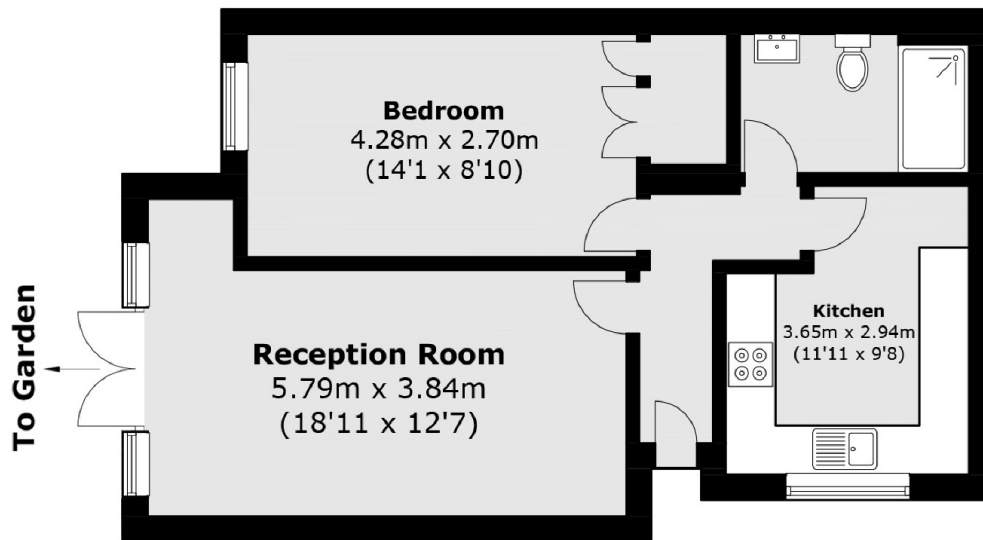

Total area (approx.): 52.86 sq. m (568.98 sq. ft)