



**Tolworth Park Road, KT6**

**£739,950**

**Dexters**



## Tolworth Park Road, KT6

A beautifully presented detached two reception room, three double bedroom home, with a landscaped rear garden and fully equipped home office.

On the ground floor this property offers a bayfronted reception room, a stunning extended integrated kitchen/dining room, a cloakroom and a double bedroom.

On the first floor there is an immaculate bathroom and two further bright and spacious double bedrooms.

To the rear is a good size south facing garden with a wonderful home office space/gym as well as space for storage and bikes.

Tolworth Park Road is just over half a mile away from Tolworth's mainline train station and has easy access to the A3. Surbiton town centre and fast link train line to London is just over a mile away.

### Features

- Detached
- Three Double Bedrooms
- Extended Kitchen/Diner
- Home Office
- South Facing Garden
- Beautifully Presented













# Tolworth Park Road, Surbiton, KT6

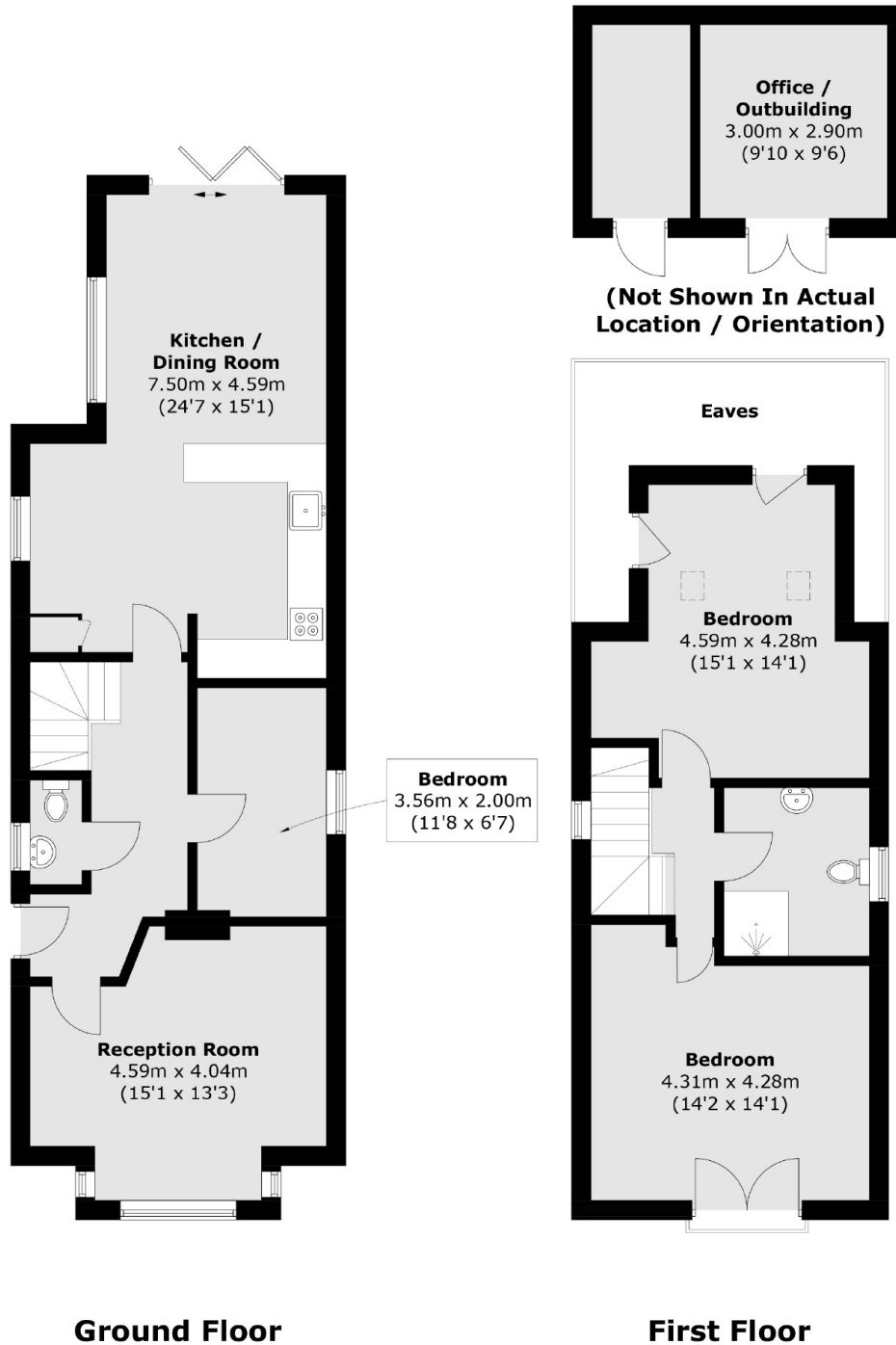

Total area (approx.): 110.7 sq. m (1191.6 sq. ft)  
Outbuilding: 13.7 sq. m (147.5 sq. ft)  
(Excluding Eaves)