



Dennan Road, KT6

£949,950

Dexters



Dennan Road, KT6

A beautiful and rare, linked-detached Victorian home with high ceilings, period features and beautiful finishes. This property offers three reception rooms, an integrated kitchen, three double bedrooms, an immaculate bathroom and a south-facing garden.

On the ground floor, there is a large, bay fronted reception room which opens up to a further living area with newly insulated wooden floors. There is a separate dining room, a kitchen with Miele appliances and access to a utility space and a guest w/c.

Upstairs, there are three beautiful, double bedrooms and a new luxury bathroom. Outside, there is a south-facing mature garden with automatic watering system and lighting. There is also an office with services.

This property currently has planning permission to add an additional 161 SqFt and has just benefitted from a new heating system with megaflo high pressure system.

Approximately one mile away from Surbiton town centre and the fast train to London Waterloo, Dennan Road is a lovely road of period properties and is close to all the amenities the area has to offer as well as some fantastic schools.

Features

- Victorian
- Linked-Detached
- Three Reception Rooms
- Three Double Bedrooms
- South-Facing Garden
- Planning Permission In Place







Dennan Road, Surbiton, KT6

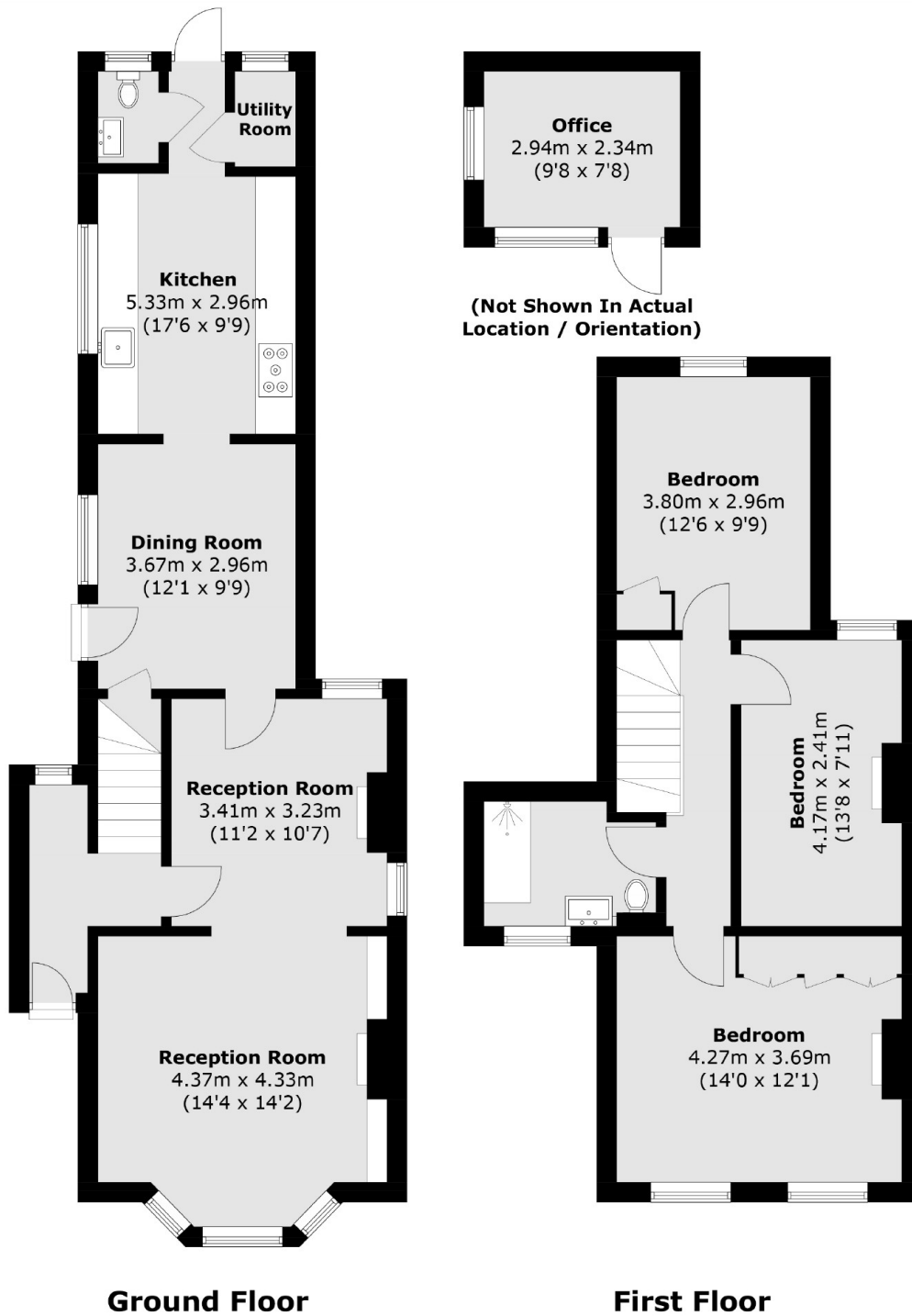

Total area (approx.): 114.1 sq. m (1,228.1 sq. ft)
Office area (approx.): 7.0 sq. m (75.3 sq. ft)