



Princes Avenue, KT6

£650,000

This semi-detached three bedroom family home has a bay fronted double reception room, a dining room, separate eat in kitchen, three bedrooms and two bathrooms. There is also a beautiful 150sq ft mature garden, off-street parking and potential to extend further (STPP).

Princes Avenue is a peaceful residential road, approximately half a mile away from Tolworth Train Station and less than half a mile away from a selection of local shops, bars and restaurants.

Features

- Semi-Detached
- Three Bedrooms
- Two Bathrooms
- 150ft Garden
- Off Street Parking
- Scope to Extend (STPP)

Princes Avenue, Surbiton, KT6

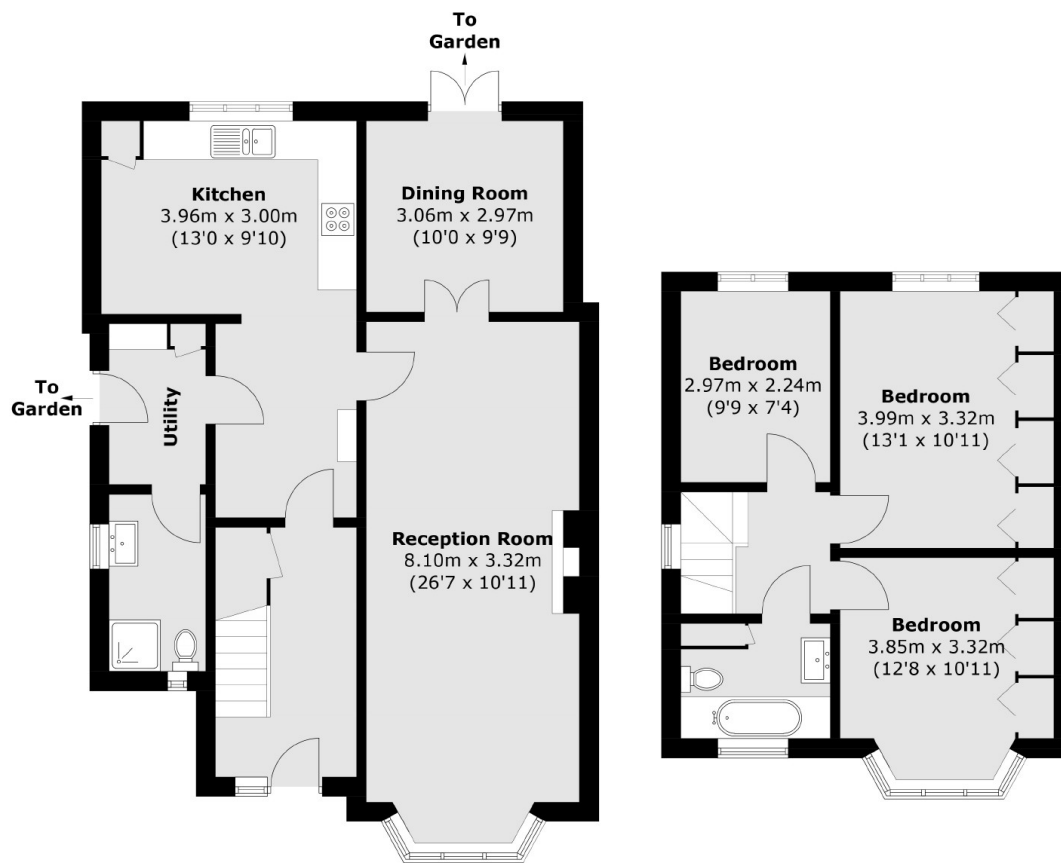

Ground Floor

First Floor

Total area (approx.): 115.6 sq. m (1,244.3 sq. ft)