



## Surbiton Hill Park, KT5

£450,000

This spacious lower ground floor apartment is peacefully nestled in an imposing Victorian villa. It has a separate private entrance, two double bedrooms, a large reception/dining room, separate kitchen with utility and a large communal garden with a private shed.

Surbiton Hill Park is just over half a mile from Berrylands station and just over half a mile from Surbiton town centre with a vast selection of local shops, gastro pubs and the mainline train station.

### Features

- Period Property
- Two Bedrooms
- Share Of Freehold
- Long Lease
- Communal Garden
- Separate Utility

# Surbiton Hill Park, Surbiton, KT5

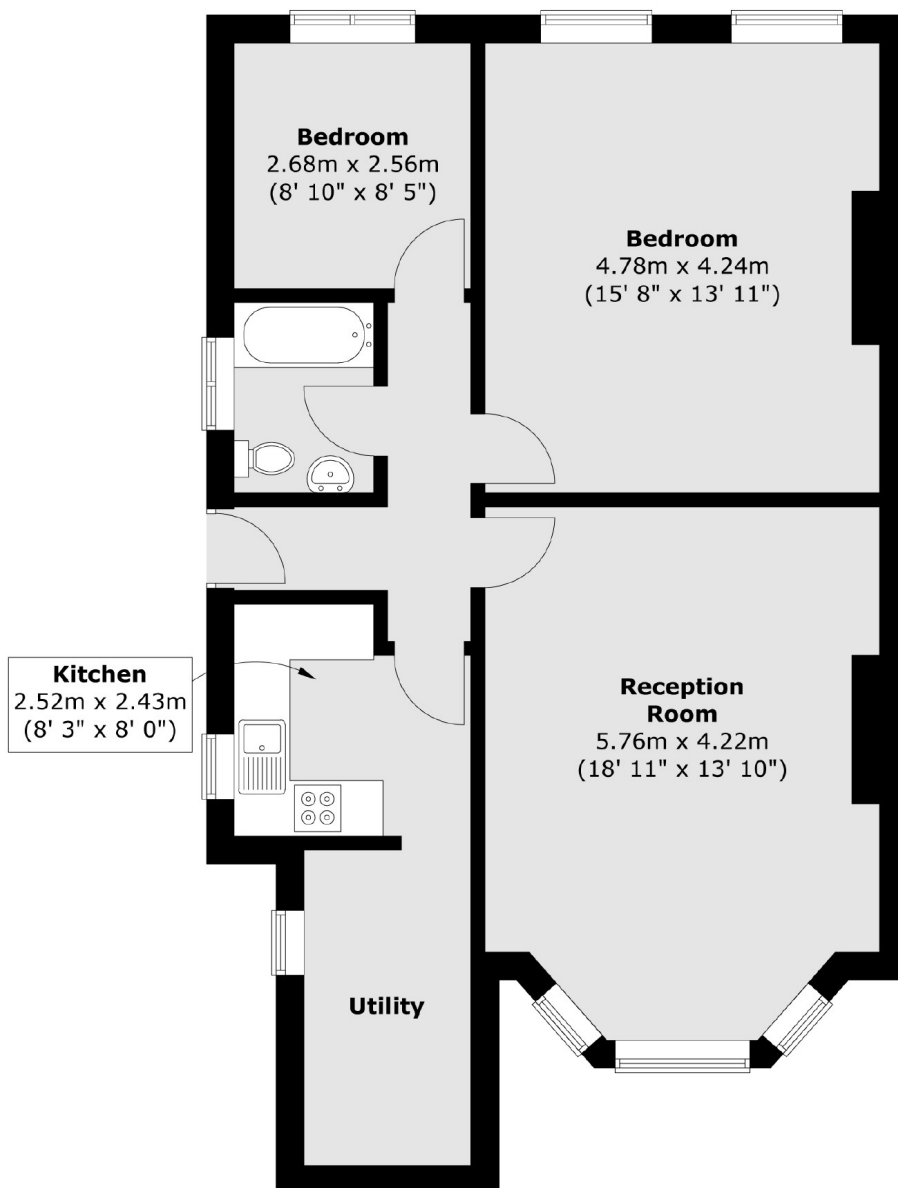

Total area (approx.) : 73.8 sq. m (794 sq. ft)