



Lenelby Road, KT6

£599,950

This beautiful two bed period property is full of character and has been recently rear extended to offer a large communal living space.

Lenelby Road is a peaceful residential road, just over half a mile away from Tolworth train station, just over a mile away from Surbiton town centre and has easy access to the A3.

Features

- Period Features
- Character And Charm
- Open Plan Kitchen/Diner
- Two Double Bedrooms
- Private Rear Garden
- Great Location



Lenelby Road, KT6

On the ground floor, there is a bay-fronted reception room. This leads through to an open plan kitchen/dining room - the perfect space to host a dinner party or get the family together.

Upstairs, there are two double bedrooms and a three-piece bathroom suite. Outside, there is a beautiful private rear garden with a patio, a lawn area and a garden shed for additional storage.

Book in a viewing now before it's too late! Call us on 020 8390 3939, email us at surbitonsales@dexters.co.uk or pop in to our local office and we will be more than happy to help.



Lenelby Road, Surbiton, KT6

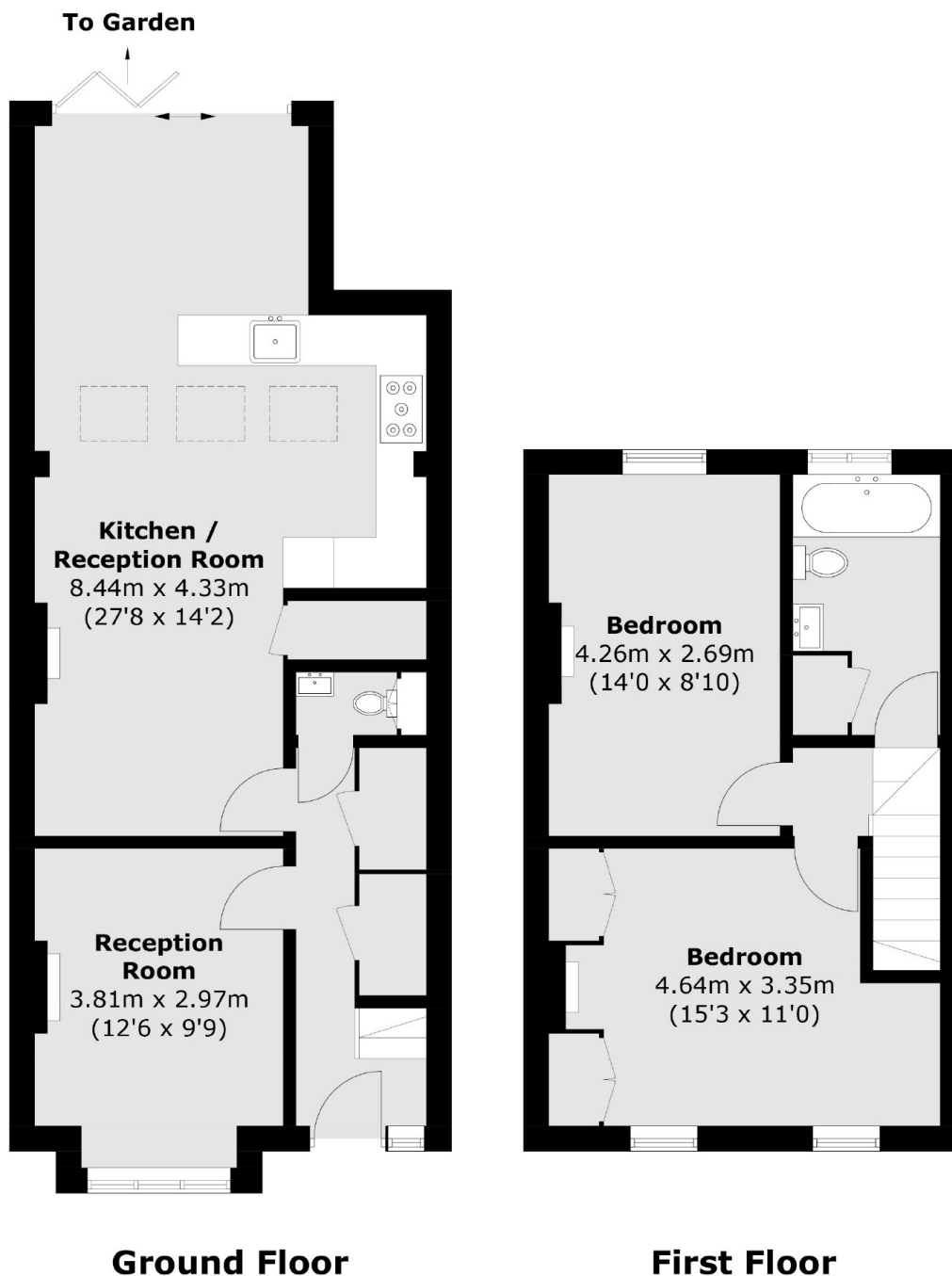

Total area (approx.): 89.7 sq. m (965.5 sq. ft)