



## Portsmouth Road, KT7

£399,950

This spacious two double bedroom first floor apartment is well presented throughout. There is good sized reception room with space to dine, a recently renovated kitchen and bathroom and two large double bedrooms. The river Rythe runs through the pretty landscaped communal gardens.

Rythe Court is on Portsmouth Road, which runs along the River Thames and is conveniently close to Surbiton's popular town centre and near to Thames Ditton village.

### Features

- Two Double Bedrooms
- Spacious Apartment
- First Floor
- Well Presented
- Communal Gardens
- Direct Access to Gardens

# Portsmouth Road, Thames Ditton, KT7

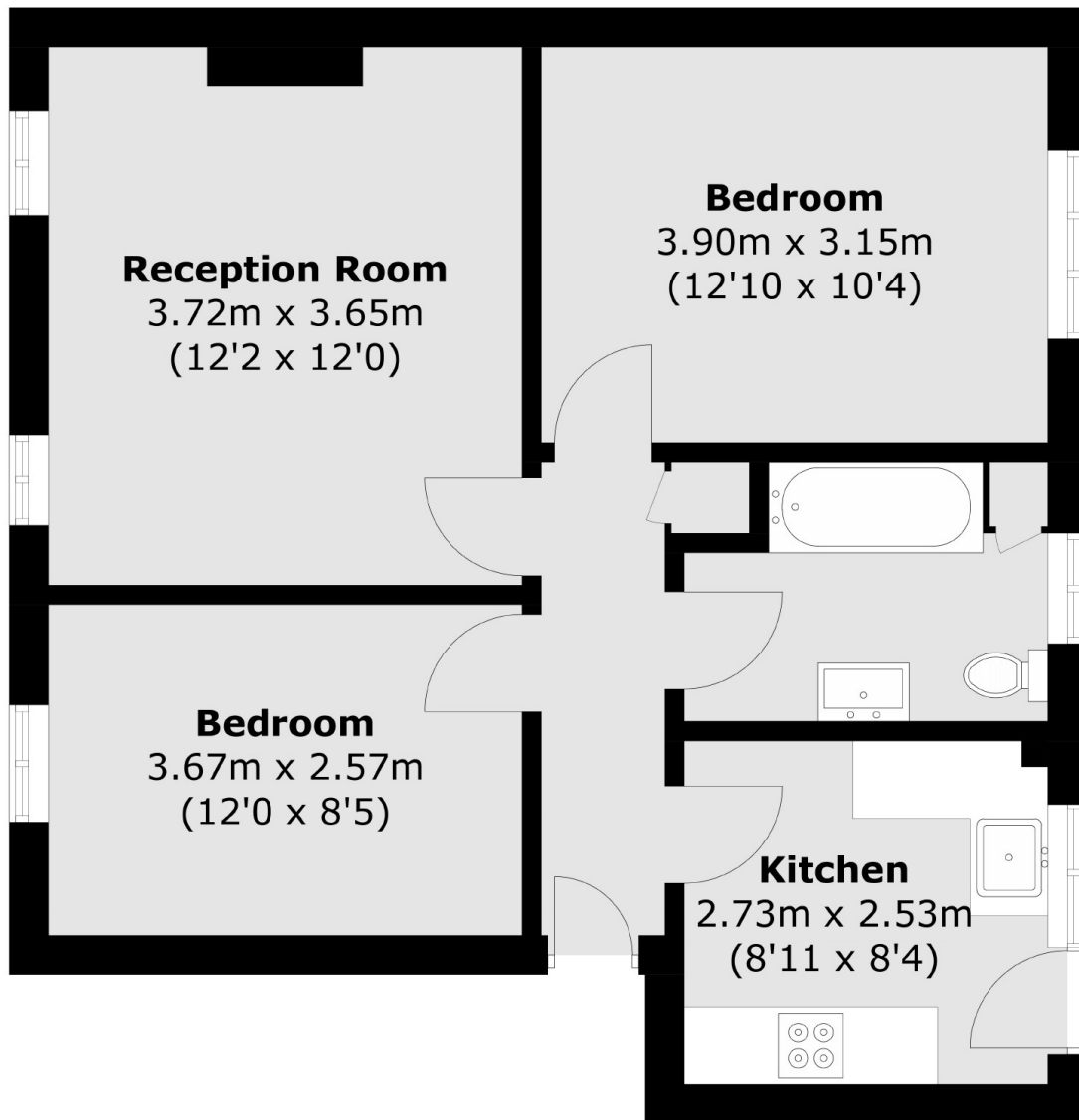

Total area (approx.): 56.2 sq. m (604.9 sq. ft)