



Cranes Park, KT5

£449,950

A bright and spacious two double bedroom ground floor flat with a large private garden and a garage. This property is centrally located, offers a separate kitchen and living area, and is set within mature grounds on a peaceful road between Kingston and Surbiton.

With Surbiton high street, the mainline train station, Kingston town centre and the River Thames all approximately half a mile away, Cranes Park is a sought after road and convenient place to live.

Features

- Two Double Bedrooms
- Large Private Garden
- Garage
- No Onward Chain
- Ground Floor
- Long Lease

Cranes Park, Surbiton, KT5

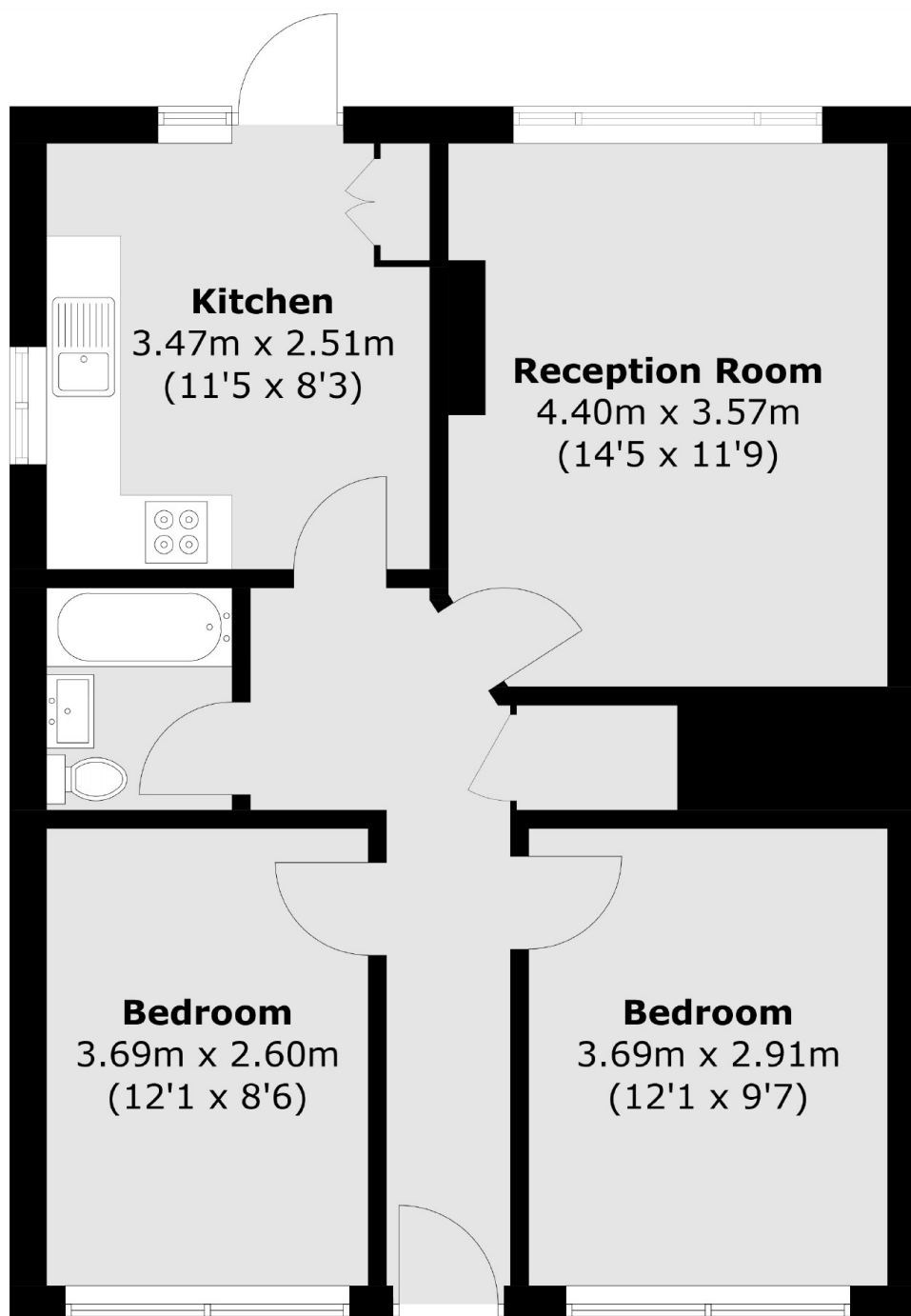

Total area (approx.): 63.2 sq. m (680.3 sq. ft)