



Chiltern Drive, KT5

£1,795,000

Dexters



Chiltern Drive, KT5

This larger than average semi detached property is nearly 2500 sq ft and is a must see for those that like a new build. It has been renovated throughout to a very high standard and offers a vast and stylish open plan kitchen/living room, four spacious bedrooms, four bathrooms, a dressing room and a state of the art home office.

On the ground floor, there is a spacious reception/dining room and brand new kitchen with bi-folding doors on to the garden, a bay fronted second reception room/fifth bedroom and a downstairs a shower room with utility area.

On the first floor, there are three large bedrooms and a show stopping family bathroom. The impressive main bedroom suite is on the second floor, along with a dressing room, an en suite shower room and a storage room.

Outside, there is a beautiful landscaped rear garden with a newly built studio with a shower room - perfect to be used as an office, a gym or extra living space. To the front of the property there is a driveway for several cars.

Chiltern Drive is nestled in the family-friendly area of Berrylands with great schools nearby, conveniently less than half a mile away from Berrylands train station and approximately a mile away from Surbiton town centre.

Features

- Renovated Throughout
- Four/Five Bedrooms
- Four Bathrooms
- Garden With Studio
- Off-Street Parking
- No Onward Chain







Chiltern Drive, Surbiton, KT5

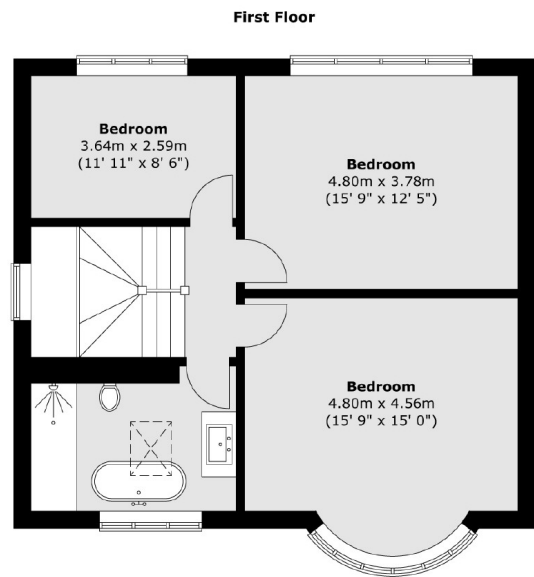
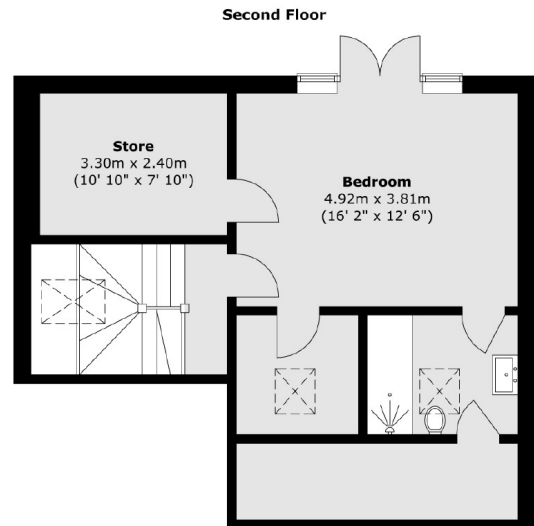
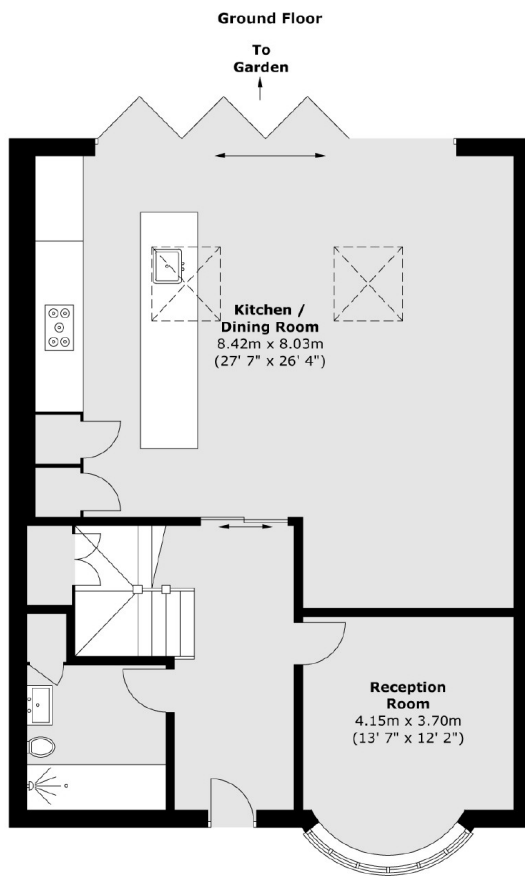
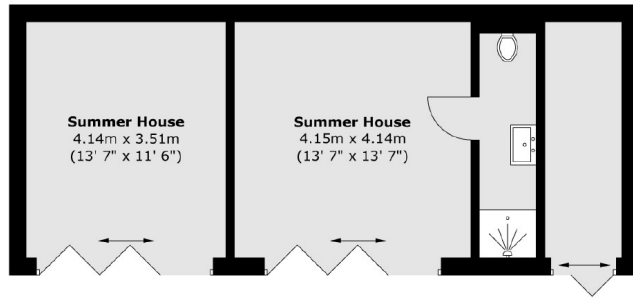

Total area (approx.) : 222.5 sq. m (2395 sq. ft)
 Total summer house area (approx.) : 37.8 sq. m (407 sq. ft)
 Total store area (approx.) : 5.8 sq. m (62 sq. ft)