



**Alexandra Drive, KT5**

**£1,350,000**

**Dexters**



## Alexandra Drive, KT5

A wonderful double fronted detached family home with four reception rooms, four bedrooms and a double garage. This property has scope to extend (STP) and improve further, is over 2000sqft and has wonderful views over the croquet club and is moments from Alexandra Park.

On the ground floor there are reception rooms on either side of the entrance hall, both with large bay windows and one with a feature fireplace. There is a beautiful bright dining space and an additional reception room with a vaulted ceiling and family kitchen with room for dining.

Upstairs there is a four piece family bathroom and four spacious bedrooms, two with bay windows, one with built in wardrobes and there is also scope to extend further into the loft and to the side (STPP).

Externally to the rear, there is a lovely 70ft mature rear garden with patio and lawn plus a double garage to the rear. To the front there is a mature and pretty walled garden and views over Surbiton croquet club.

Alexandra Drive is a sought-after tree lined road, close to some fantastic schools and just over half a mile from Surbiton town centre and train station. It has wonderful views of the croquet club and is moments from the entrance to Alexandra Park with tennis facilities.

### Features

- Detached
- Four Bedrooms
- Four Reception Rooms
- Feature Fire Place
- Off-Street Parking
- Garage







# Alexandra Drive, Surbiton, KT5

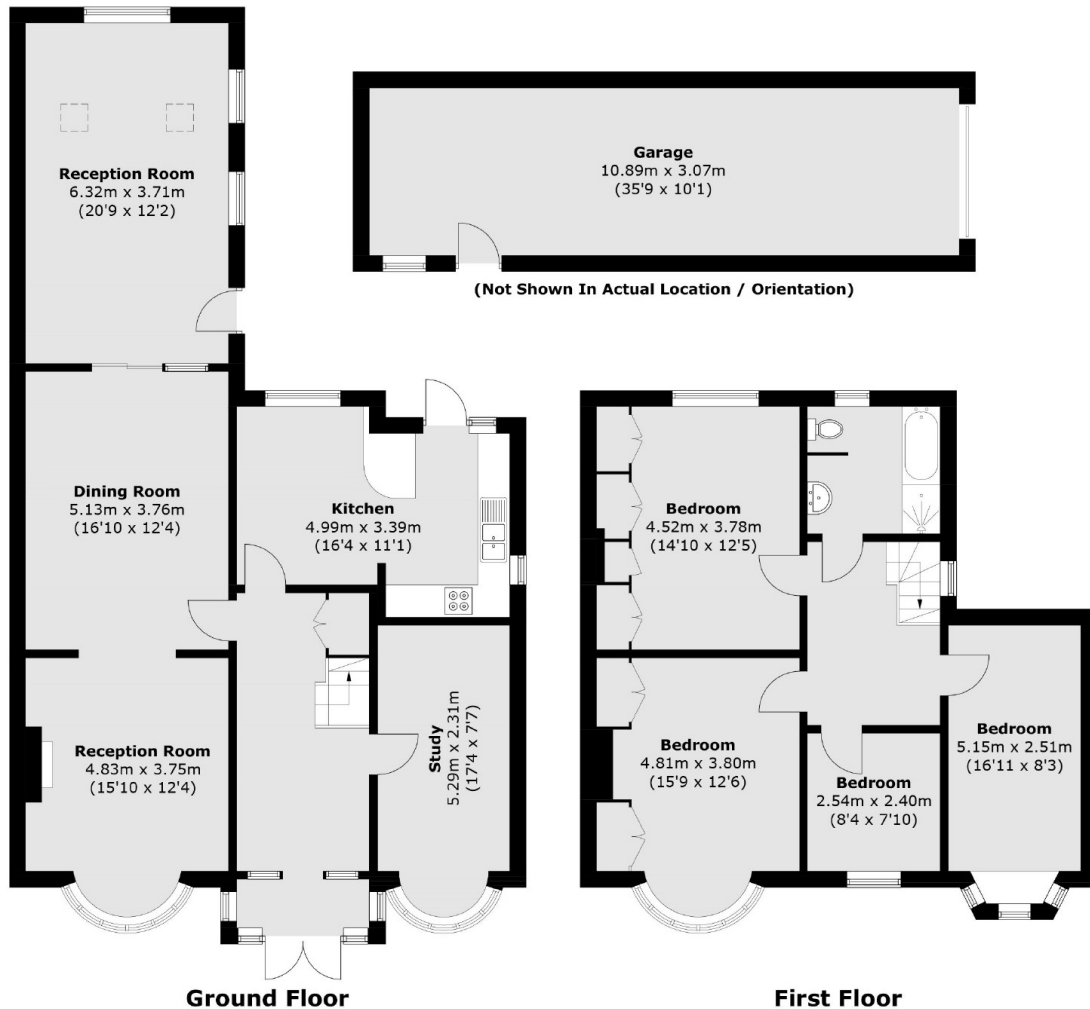

Total area (approx.): 176.2 sq. m (1,896.6 sq. ft)  
Garage: 33.9 sq. m (364.9 sq. ft)