



Etwell Place, KT5

£650,000

A three storey town house providing adaptable accommodation three bedrooms, two reception rooms, kitchen, cloakroom, bathroom, garage, garden and off street parking.

Etwell Place is around the corner from Ewell Road which offers a selection of bars, restaurants and local shops. The property is less than half a mile to Surbiton station, which has fast links to Waterloo.

Features

- Townhouse House
- Versatile Accommodation
- Central Location
- Off Street Parking
- Private Garden
- Investment Opportunity

Etwell Place, Surbiton, KT5

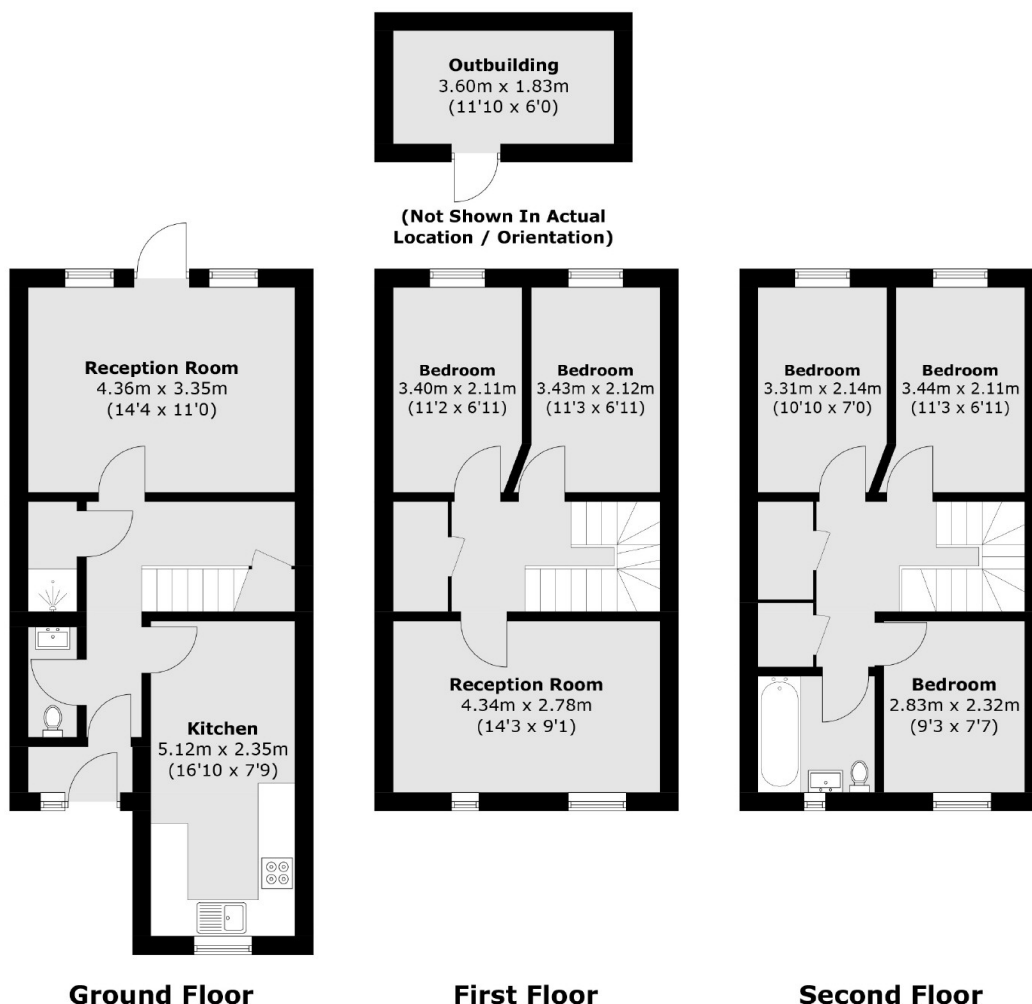

Total area (approx.): 113.5 sq. m (1,221.6 sq. ft)
Outbuilding area (approx.): 6.8 sq. m (73.2 sq. ft)