



## Cranes Park Avenue, KT5

£810,000

A wonderful property full of potential. Currently offering three large reception rooms with high ceilings, three double bedrooms and a bathroom. To the rear is a large private garden and there is a separate garage. This property could be extended to the rear and in to the loft to create a wonderful family home.

Cranes Park Avenue is half a mile away from Surbiton mainline train station with its fast links to Waterloo, Surbiton town centre with a vast selection of shops, bars, restaurants and the farmers market is close by as is Kingston town centre.

### Features

- Semi Detached
- Ready To Develop
- Large Rear Garden
- No Onward Chain
- Scope To Extend STP
- Garage

# Cranes Park Avenue, Surbiton, KT5

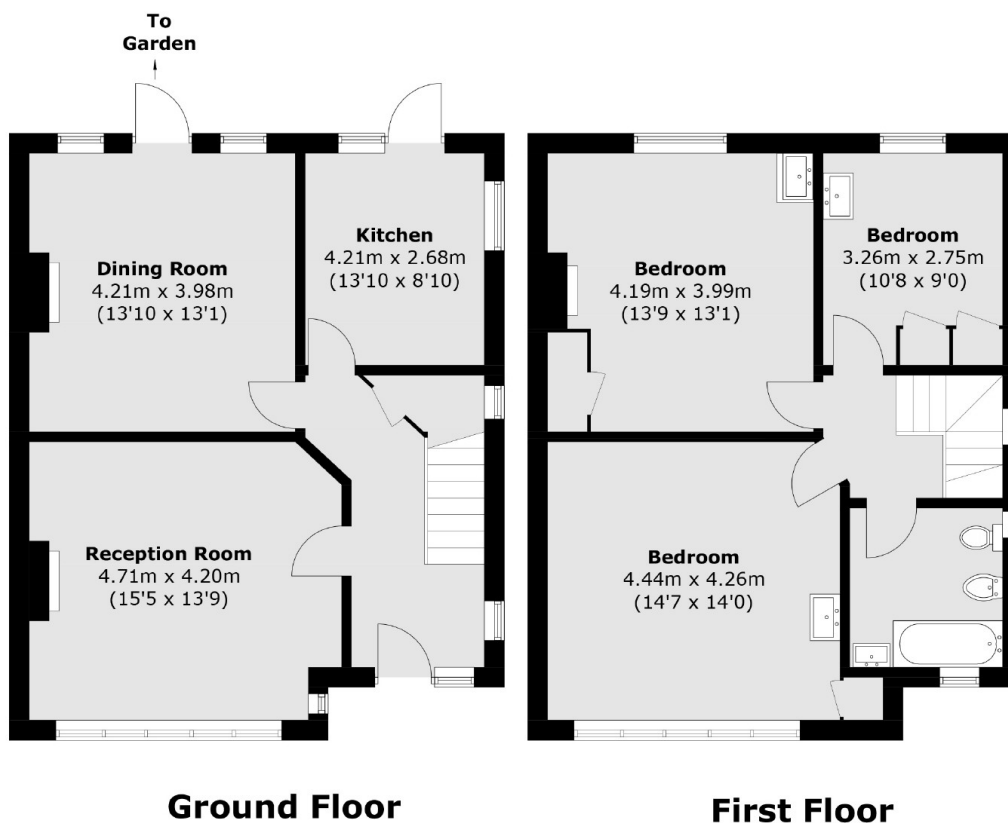

Total area (approx.): 113.9 sq. m (1,226.0 sq. ft)