



## St. Marks Hill, KT6

£399,950

This second floor apartment is offered to the market with no onward chain and includes a bay-fronted reception room, a fitted kitchen, two double bedrooms and a bathroom with a separate w/c.

St Marks Hill is nestled in the heart of Surbiton with everything you need on the doorstep, including the mainline train station and a variety of shops, bars and restaurants.

### Features

- Second Floor
- Ample Storage
- Two Double Bedrooms
- No Onward Chain
- Efficient Transport Links
- Central Location

# St. Marks Hill, Surbiton, KT6

## Second Floor

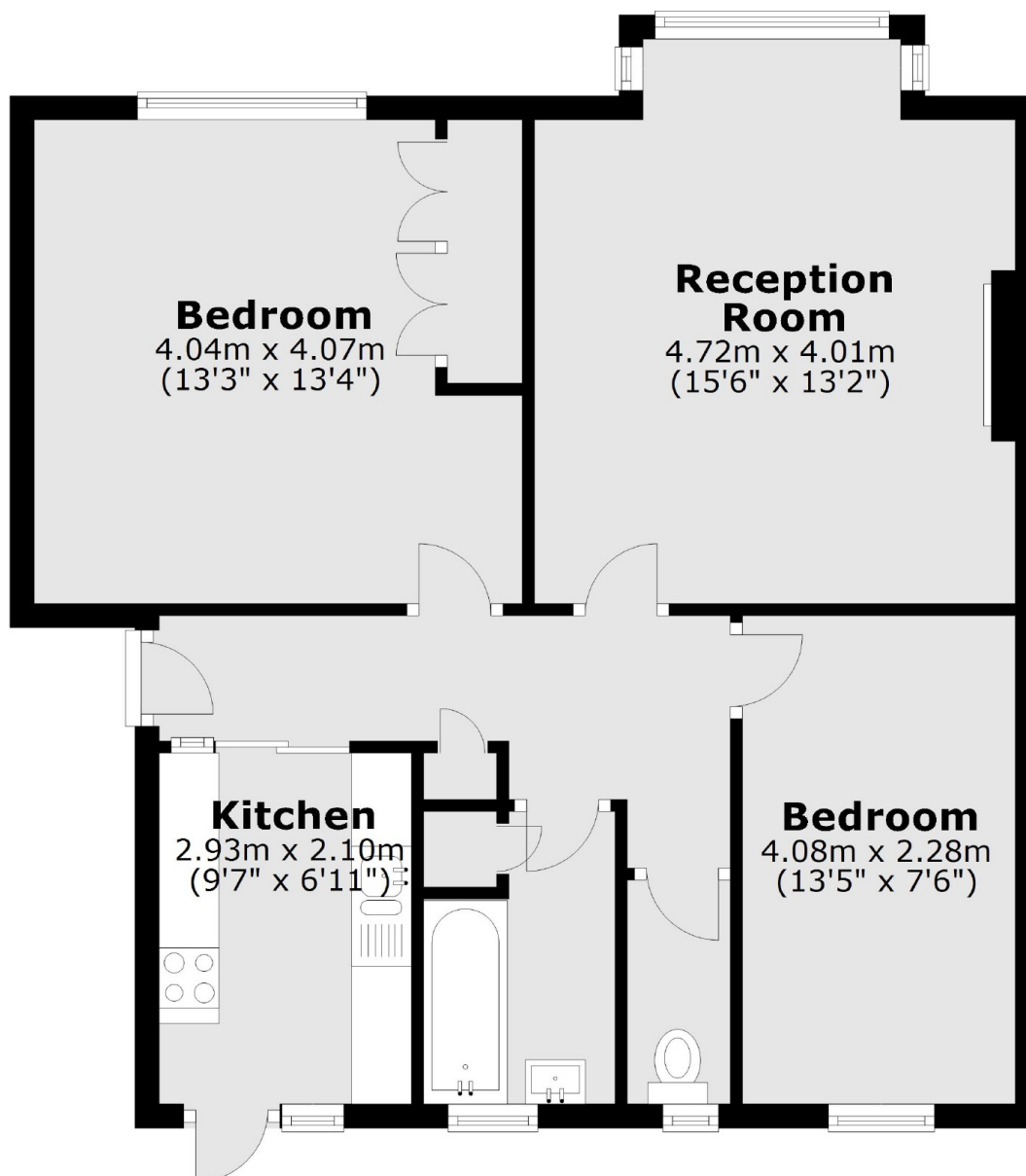

Total area: approx. 64.4 sq. metres (693.2 sq. feet)