



Manor Road North, KT7

£1,450,000

Dexters



Manor Road North, KT7

Originally built in the 16th Century and serving as the old farm house to Henry VIII's Hampton Court, this five bedroom, four reception room historical home is set within a third of an acre of beautiful grounds.

This property was extended in the 17th and 19th century and is Grade II listed, original features include the windows, wooden beams, large brick built fireplaces, a storage room for farm produce and a sunken garden.

The property is well laid out with the front door leading in to the gallery with arched windows, there is a large eat in kitchen, several characterful reception rooms, a utility room and a cellar. Two stair cases lead up the the first floor.

Altogether there are five good size bedrooms, three bathrooms, several outbuildings, including an office and wonderful mature grounds surrounding the property on all sides. There is off street parking for several cars and an electric charging point.

This property is located 0.6 miles from Hinchley Wood train station with easy links in to London Waterloo. It is in the catchment for the fantastic Hinchley Wood School and Thames Ditton and Surbiton town centres are also nearby

Features

- Historical Home
- Grade II Listed
- A Third Of An Acre Of Grounds
- Four Reception Rooms
- Five Double Bedrooms
- Off Street Parking







Manor Road North, Thames Ditton, KT7

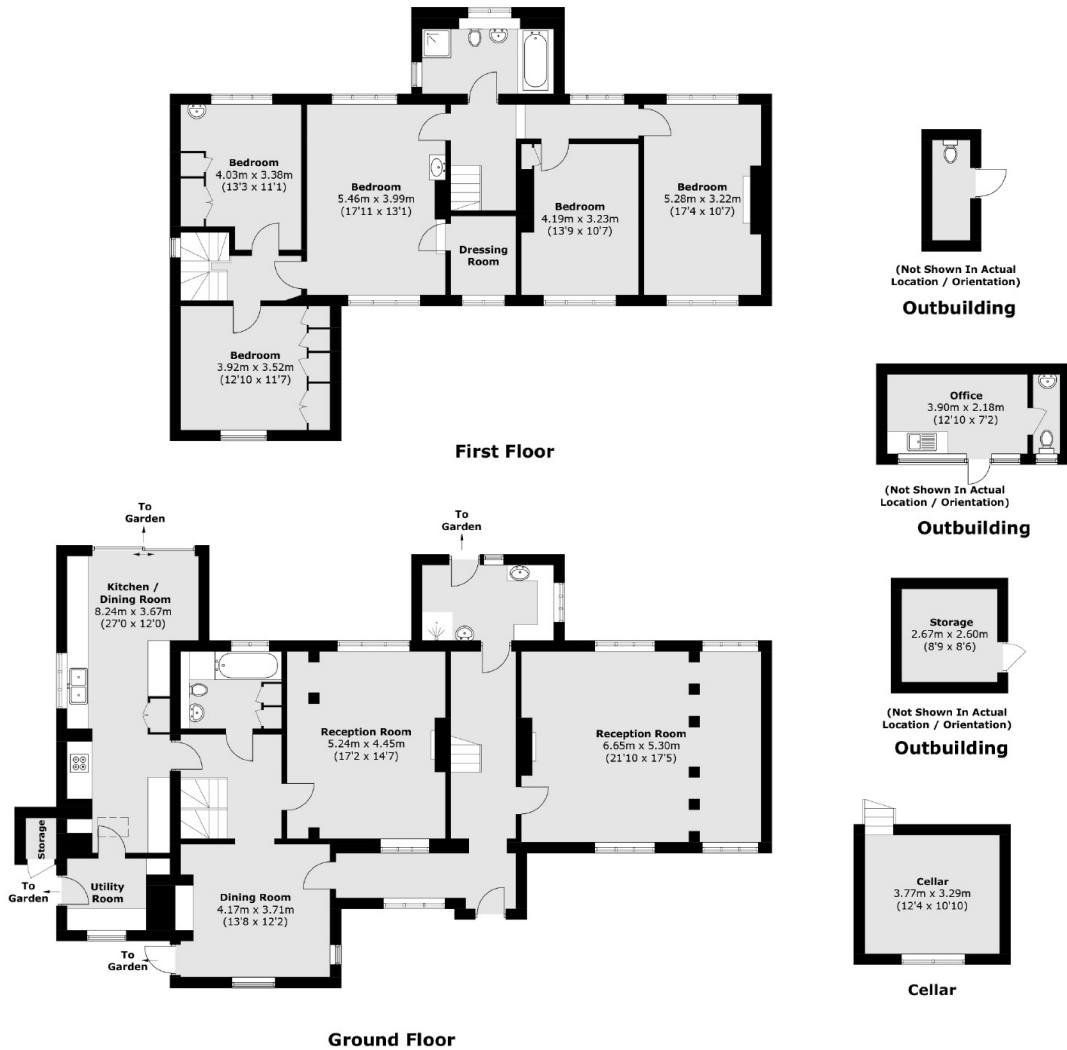

Total area (approx.): 275.8 sq. m (2,968.6 sq. ft)
Outbuildings area (approx.): 21.7 sq. m (233.5 sq. ft)